

# Mute PET Felt Acoustic Panels Installation Guide

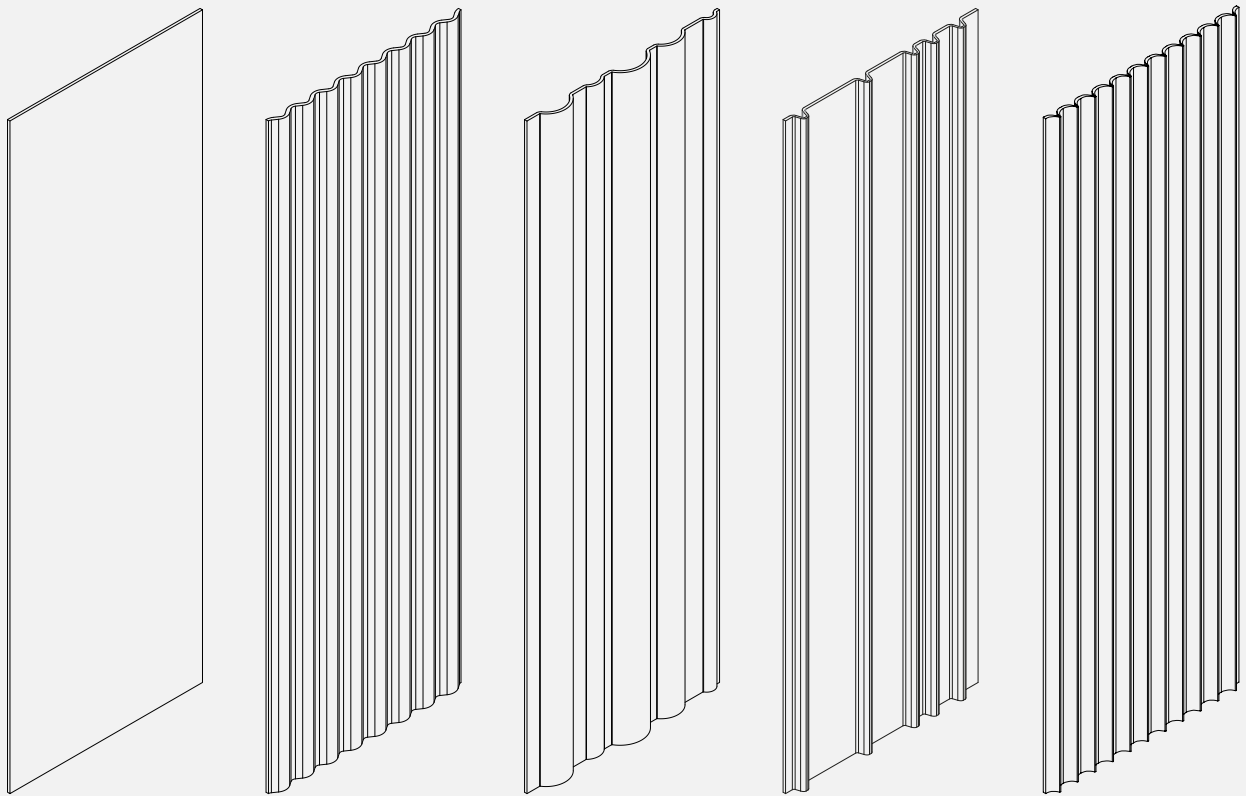

DeVorm

# Tools

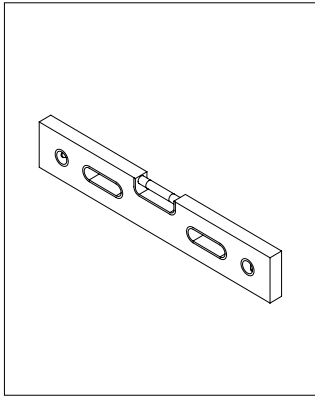

Level

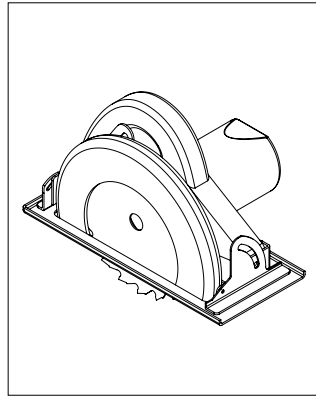

Circular saw

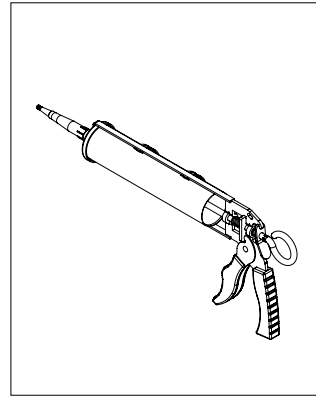

Glue gun

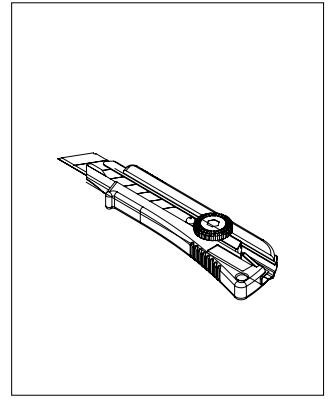

Snap-off  
blade cutter

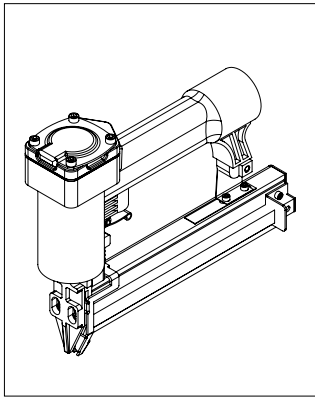

Nail gun

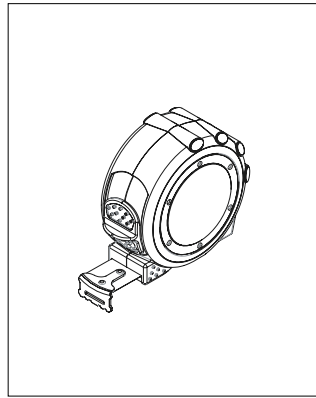

Measuring  
tape

# Panels

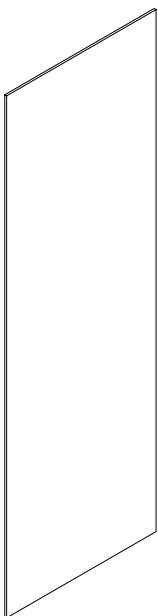

Mute Flat

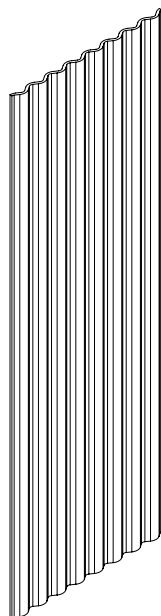

Mute Flow

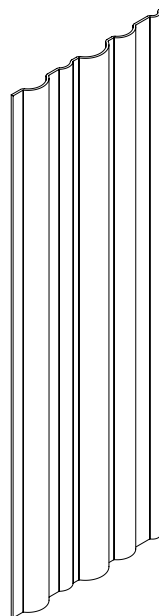

Mute Fit

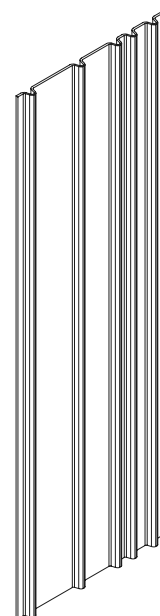

Mute Fraction

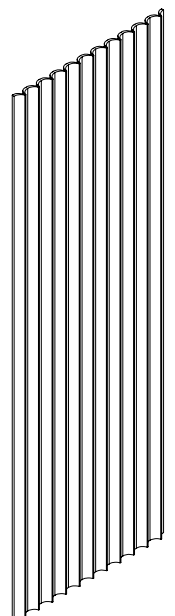

Mute Peak

## Before you begin



Since PET Felt panels are made of recycled material, they may have slight colour differences.

To keep the colour differences to a minimum, we advise installing the panels in the same order as stacked in a box, keeping the top of the panel as the front side.

Please note that there may be minor discrepancies in stated size.

PET Felt panels should be handled carefully during transportation and unloading. The dimensions and flexibility of a single panel usually require two people to lift it.

If you install the Mute panels with a fire retardant treatment, make sure to mount them on a non-combustible background and / or use non-combustible mounting materials.

Fire treatment may cause slight deviations in the appearance of the panels, visibility of which varies per PET Felt colour. These deviations will usually disappear over time - it might take 4 to 6 months.

To achieve the most seamless transition between the panels, it is important to place them tightly against each other. You can do this by firmly pressing a loose panel against the already installed part before attaching it.

# Installation order

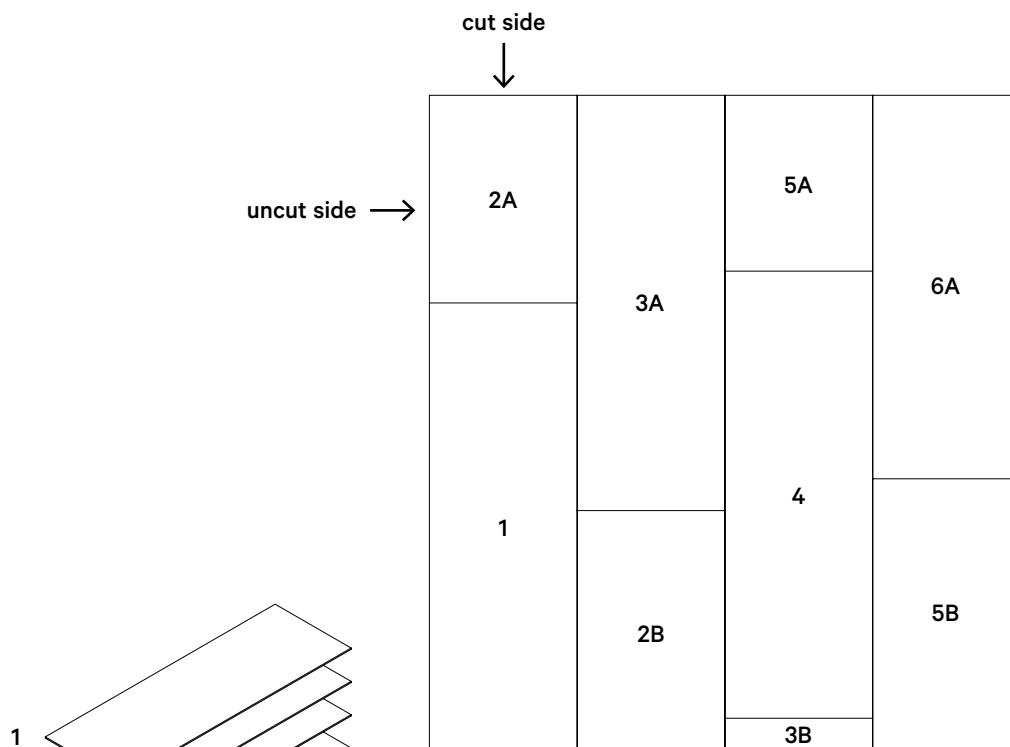

If you need to stack the panels, we advise you to use the pattern as shown here. An asymmetric pattern ensures that the colour differences are less visible. Always place the cutting side on the outside (ceiling or floor side).

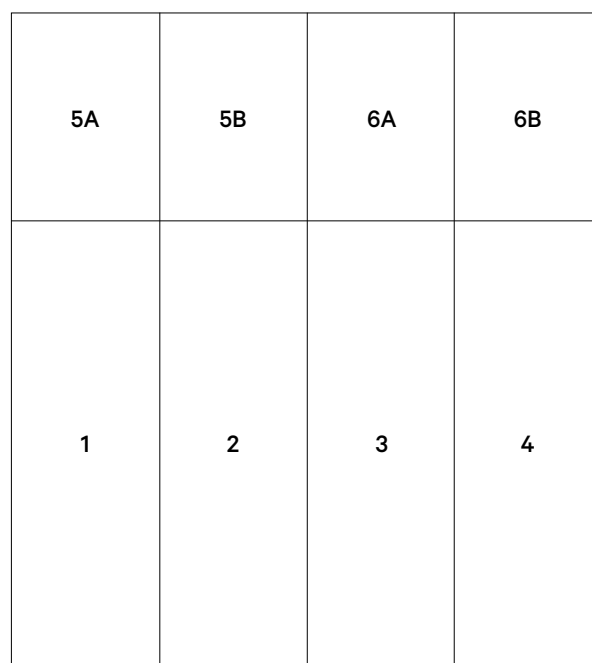
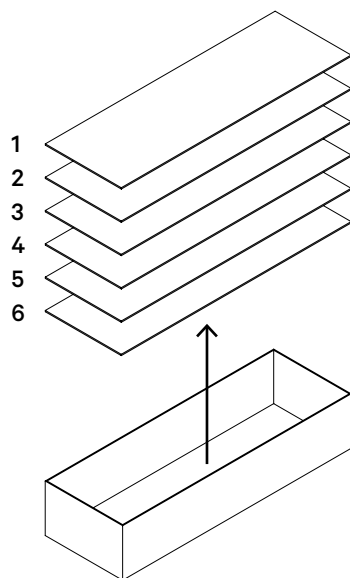

Never use one panel to fill the missing smaller pieces. We advise cutting / installing the panels in the same order as stacked in a box to avoid colour differences.

# Cutting panels to size

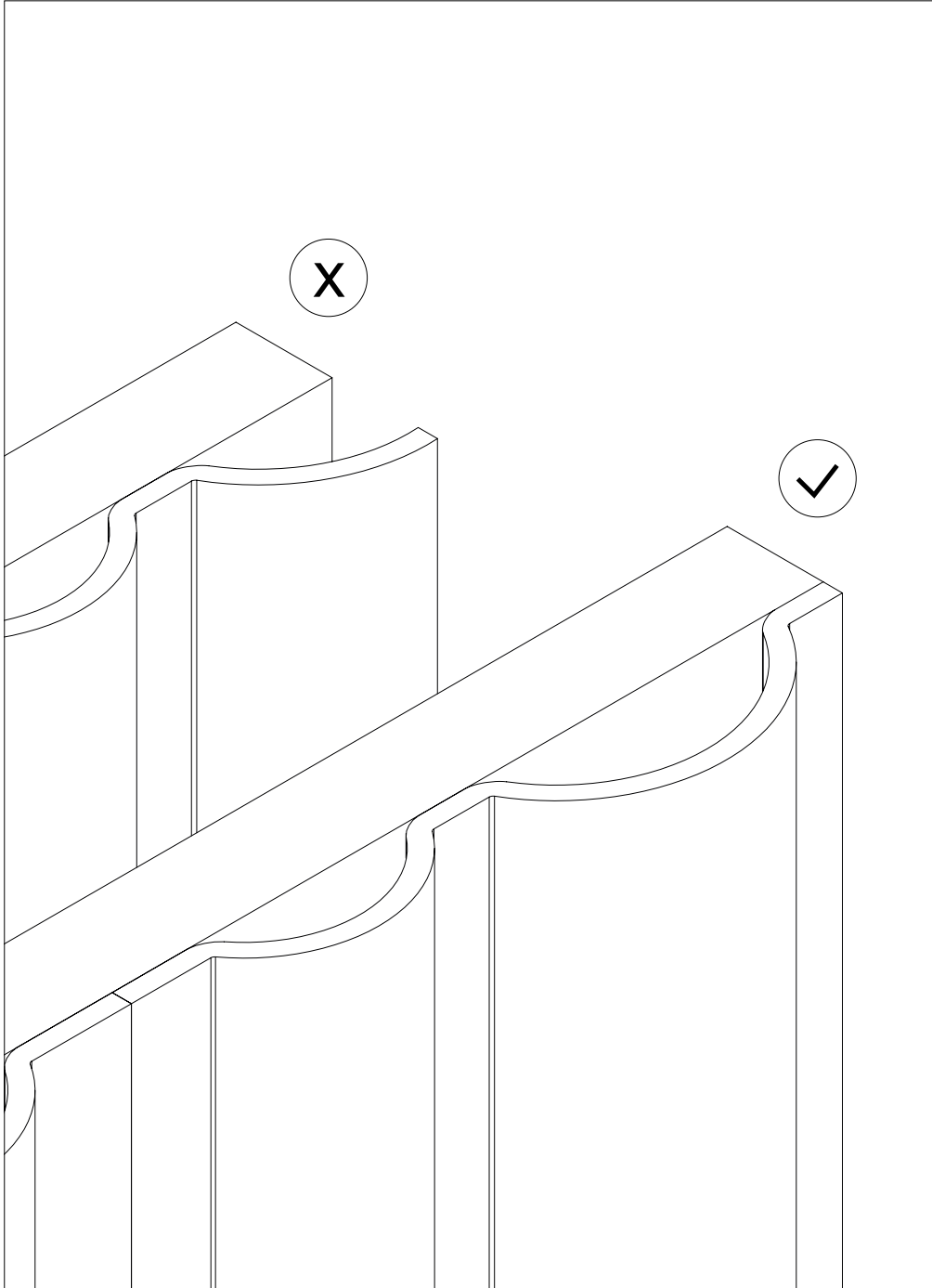

PET Felt panels can be cut using a circular saw or a blade cutter.

## Circular saw

The best way to cut PET Felt panels is using a circular saw. We recommend testing the speed of the saw first to prevent the material from melting. If the cut sides of the panels get too rough, you can gently smoothen them with sanding paper.

## Blade cutter

Smaller, tailor-made cut-outs and alterations can be made on-site with a snap-off blade cutter and a ruler.

Define how you would like to cut the panels. If a panel has flat areas in its pattern (such as Mute Fit\* or Mute Fraction\*\*), make sure that every part you cut is flat at the edges.

You can draw the reference markings for the cutting lines on the backside of the panel.

\*See Appendix 1 for the measurements of Mute Fit

\*\*See Appendix 2 for the measurements of Mute Fraction

# Installation using an adhesive

## 1 Prepare the surface

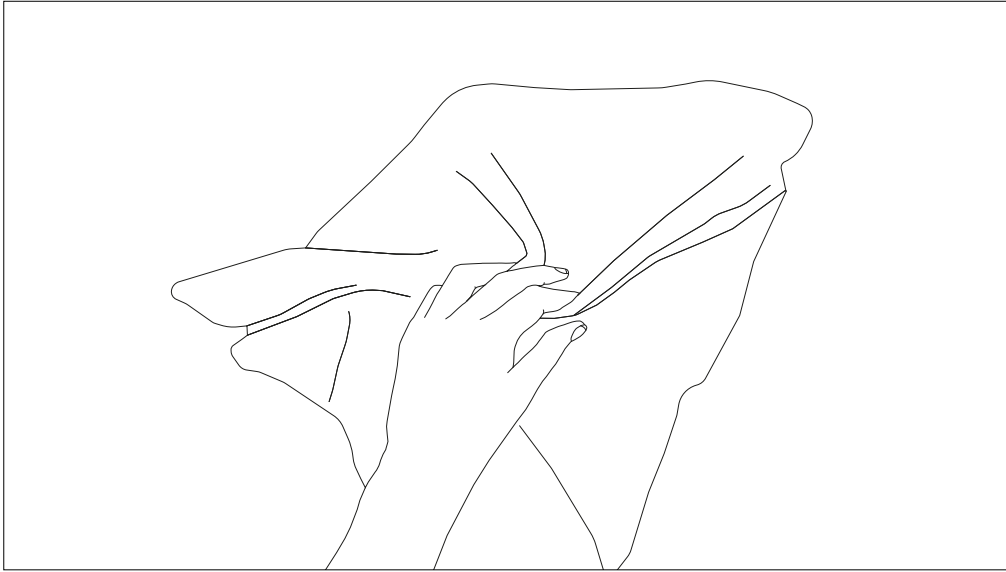

**Make sure the surface is flat and clean.**

## 2 Apply the adhesive

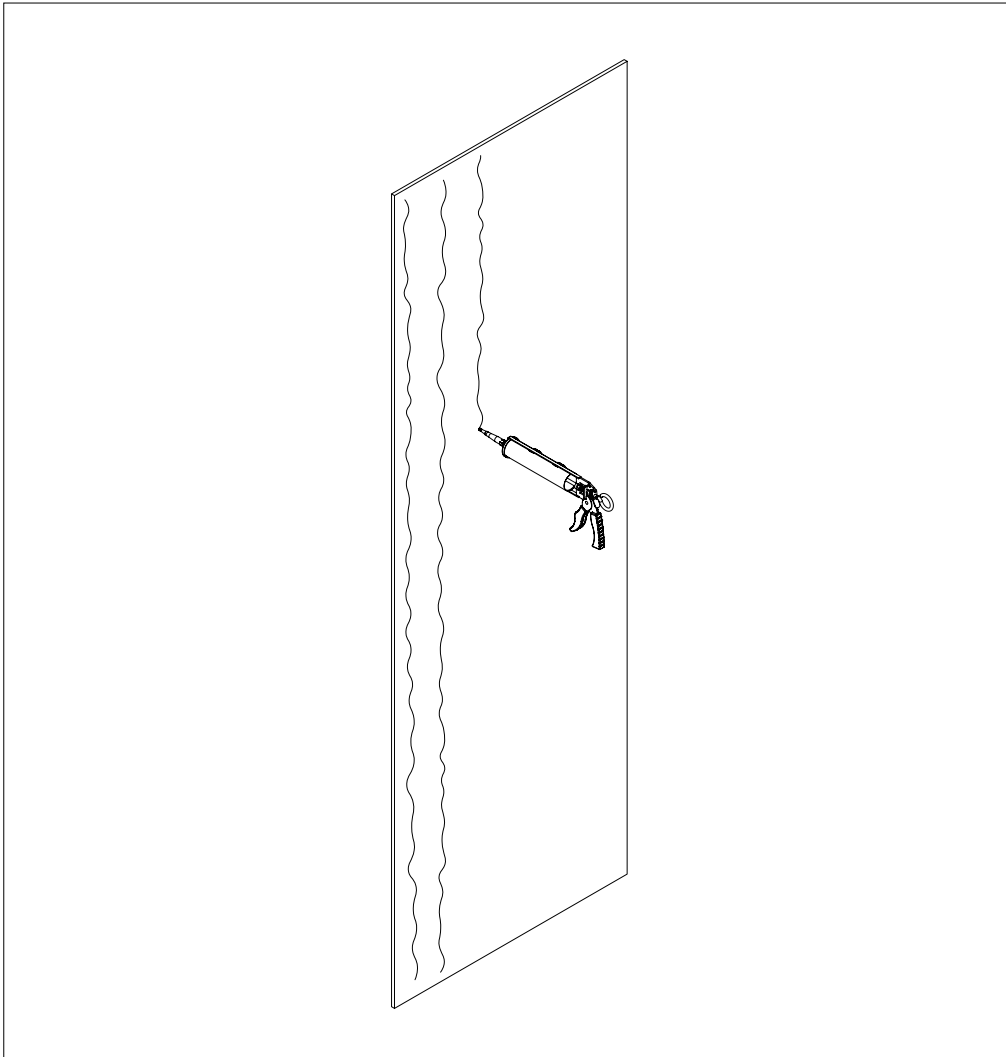

**Apply the adhesive on the backside of the panel following the manufacturer's instructions.**

### 3 Mount the panels

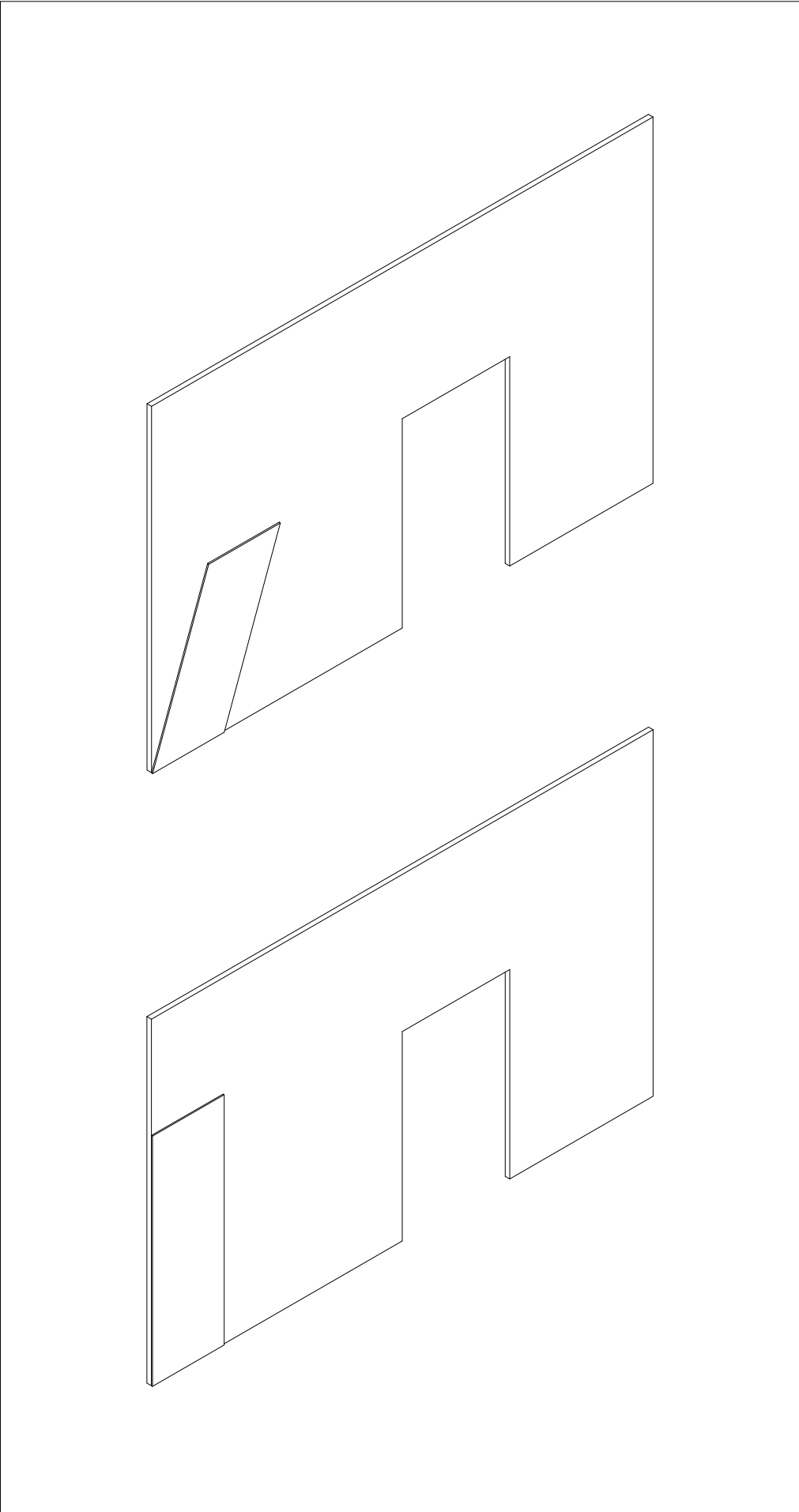

Place the panel against the surface, starting at the bottom. Make sure it is properly aligned, you can use a level to check that.

Press the panel firmly against the surface, making sure that corners and edges are properly attached.

Repeat these steps until the installation is complete.

**4** Allow the adhesive to cure

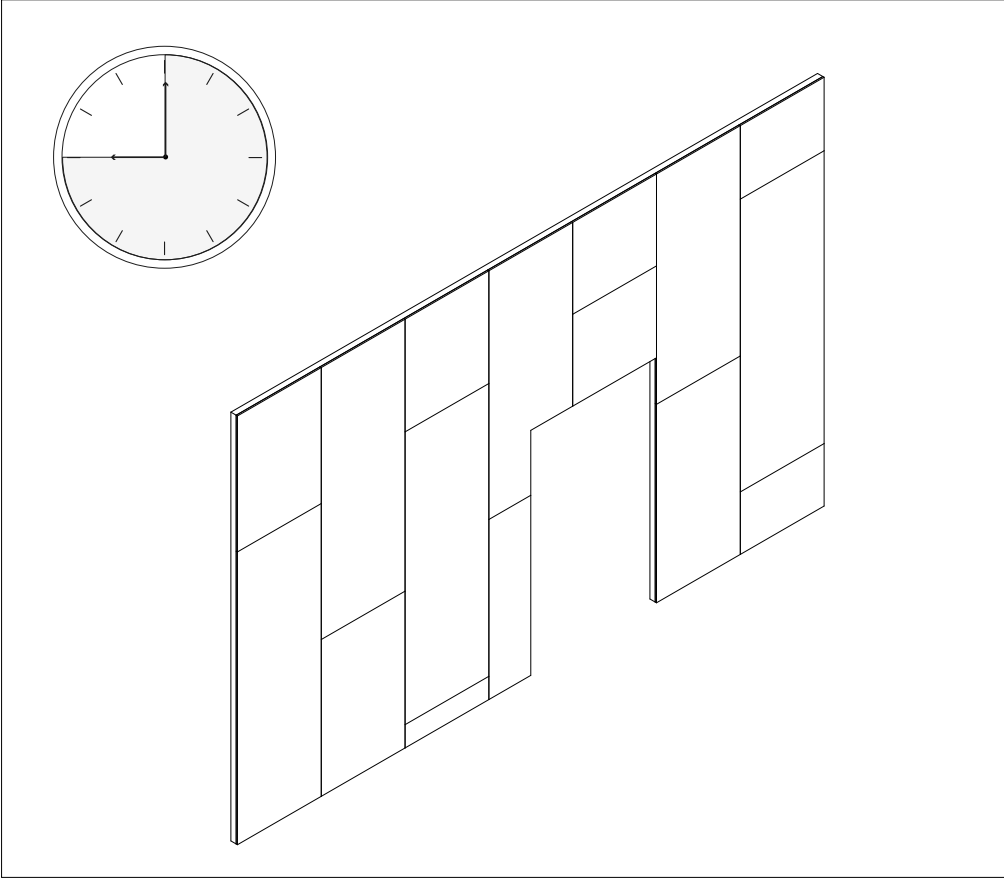

The curing time may vary, follow the adhesive manufacturer's instructions.



# Installation using a nail gun

## 1 Prepare wooden framework

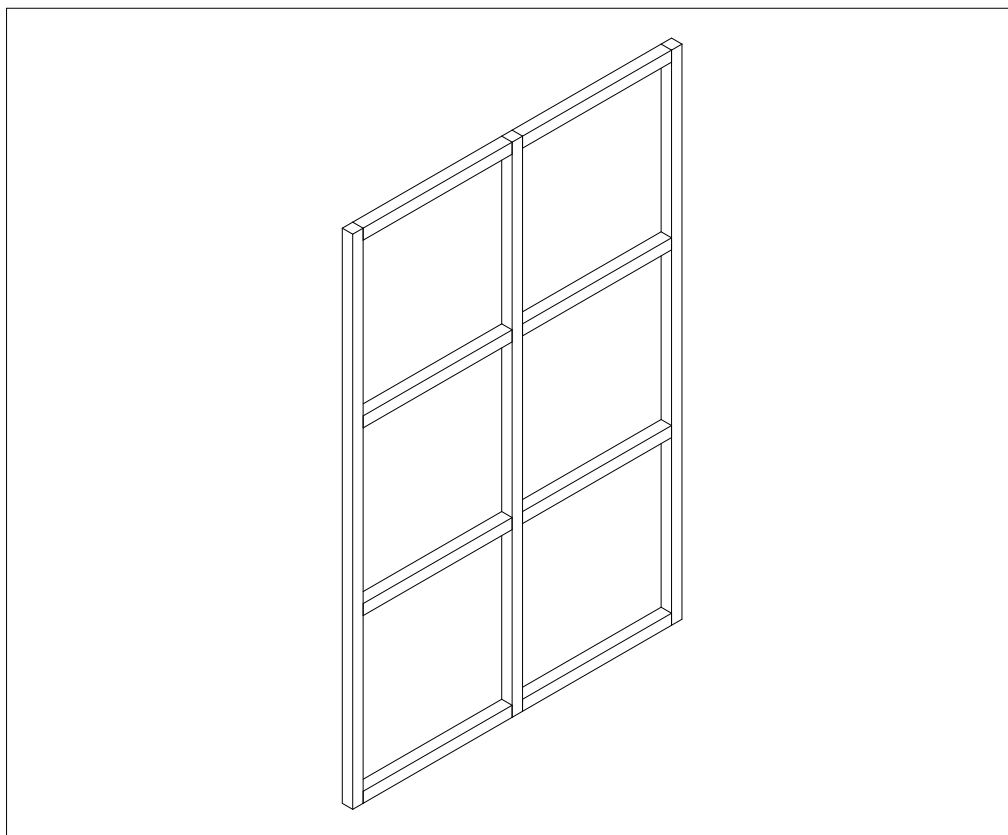

A wooden framework is necessary if you install the panels using a nail gun.

Make sure the frame is levelled. You can use a level to check that.

## 2 Install the panels

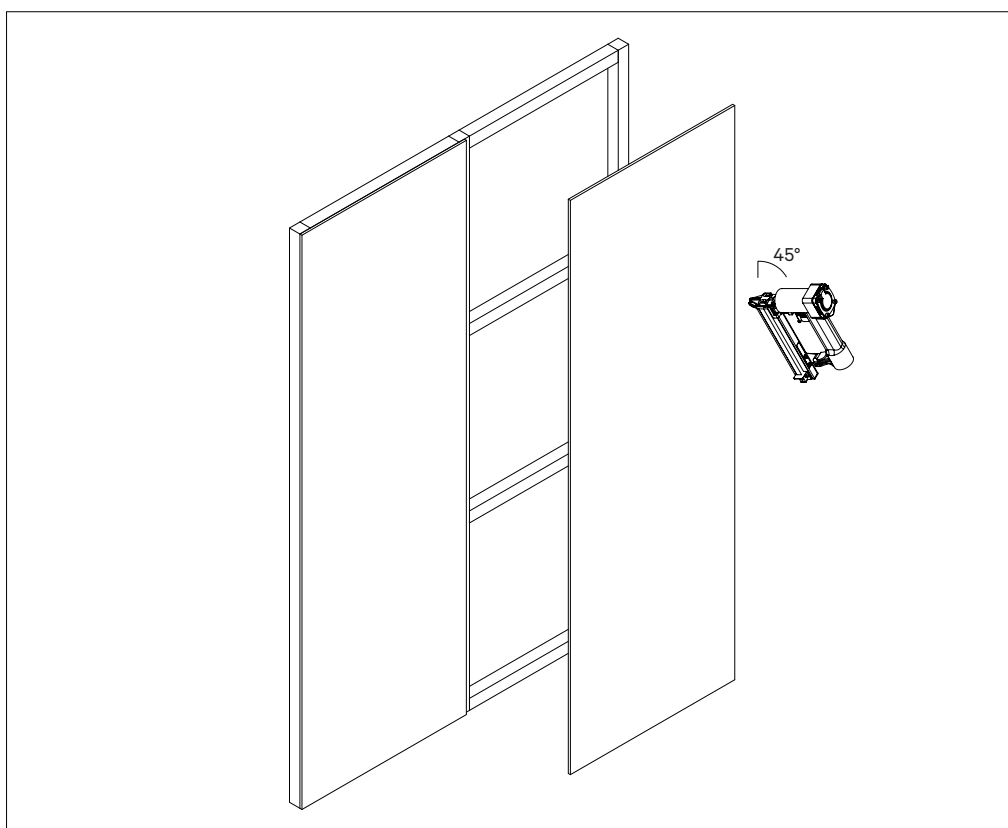

Test the pressure of the nail gun and adjust it, so that the nails don't go too deep into the material.

For a better grip of the headless nail, the nails should be applied at an angle of approximately 45°.

# Appendix

## Mute Fit

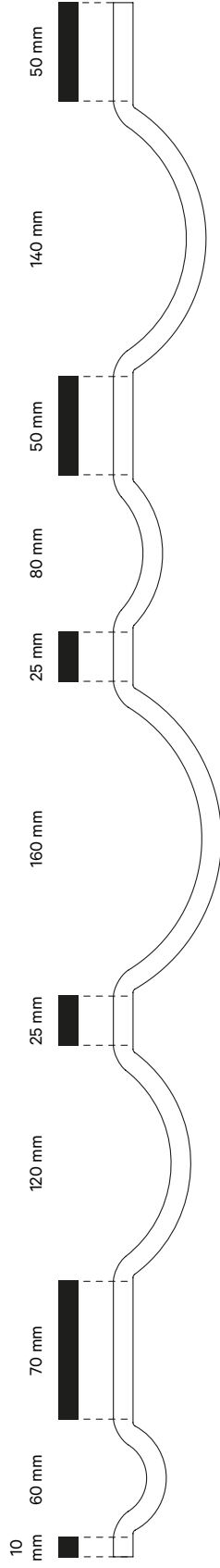

## Mute Fraction

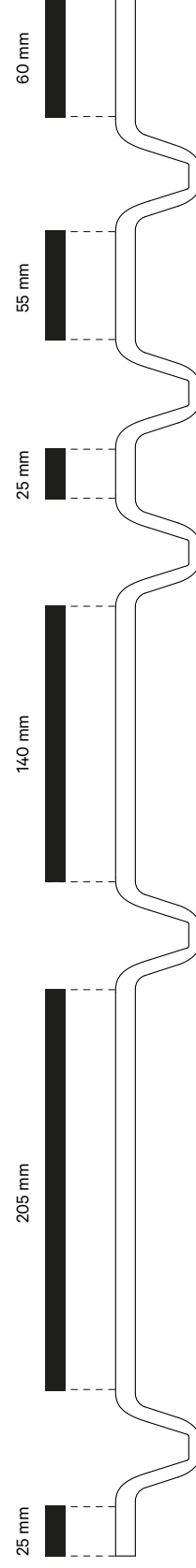

# DeVorm

## We create interior products by today's standards.

De Vorm is established in a new era, we develop products by the standards of today. This means we produce efficiently, use the full lifecycle of products and eventually give them a new life.

Our emphasis lies on making a product that works, by setting a variety of conditions; it should be legible, accessible, but also environmental friendly and aesthetically perfectly in balance.

## We like a product because of its functionality.

A good product makes life easier — it should be developed for helping us function better throughout the day. We firmly believe that the beauty of a design lies in the sum of functions that makes it a complete product.

## We continuously raise the bar.

From the very first sketches we start combining and developing new techniques to find new possibilities to innovate. Our design process is infused with technical development; techniques result in aesthetic features and the other way round.