

NUT FORM



www.trikustik.at

trikustik3

THE WORLD IS SOUND.

Joachim Ernst Berendt

TRIKUSTIK is an innovative Austrian company specialising in the development and manufacturing of high-quality acoustic boards made of solid wood and wood-based materials.

Through this focus on products for room acoustic optimisation, we offer building owners, acoustic planners, architects and processors many years of expertise in the development of individual solutions and a high variance of standardised design options.

As a team, we deliberately break new ground and develop ourselves according to the principles of self-organisation.

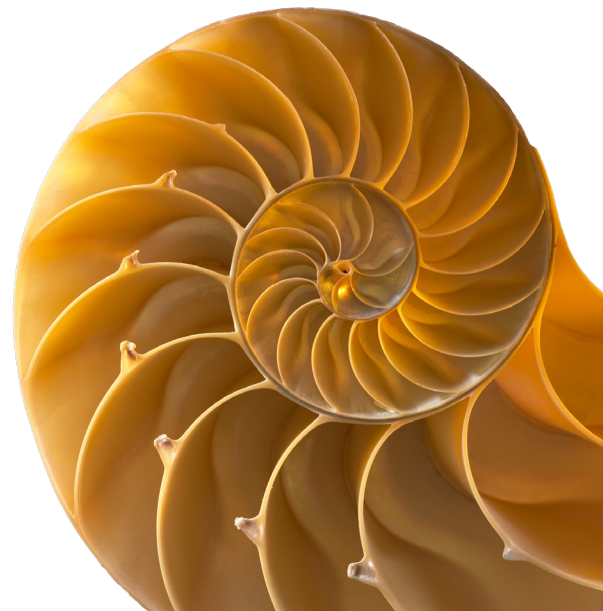

NUT FORM

ACOUSTIC BOARDS

We offer acoustic boards with linear grooved surfaces in numerous optically and acoustically different variations with different visual and acoustic effects.

These create a calm and homogeneous effect in the room. Used deliberately, the groove direction, material and colour offer great scope for design.

More reference photos on
www.trikustik.at

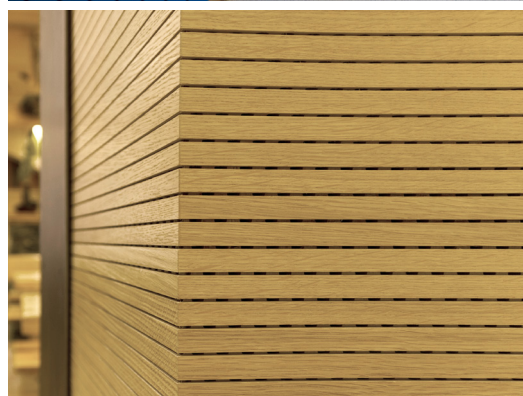
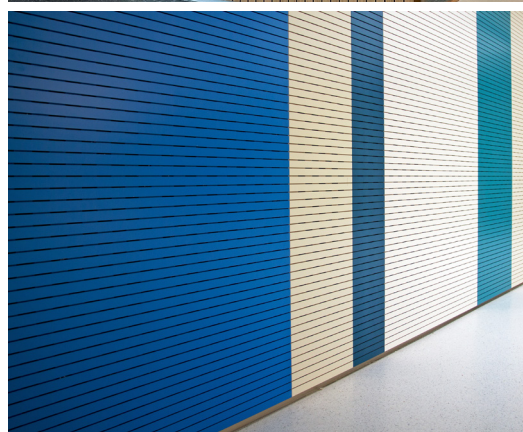
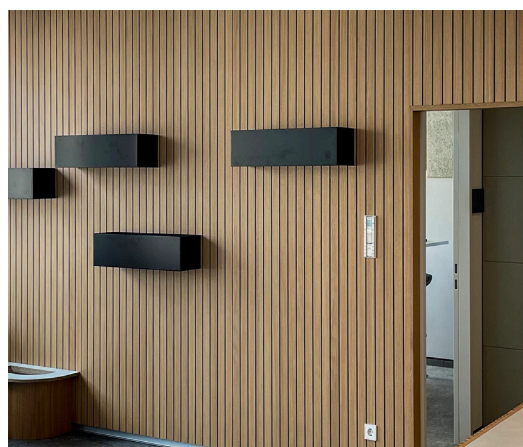
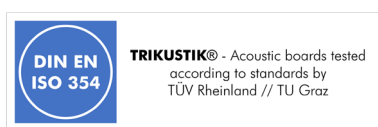

OPTIONS

DESIGN AND FORMATS

The type of finish on the back side also determines the visual effect on the front side. The „S“ variant can have a calmer effect over a large surface.

„S“ BACK SIDE WITH SLOTTED HOLES



„B“ BACK SIDE WITH DRILLED HOLES



As an alternative to the large-scale „PANEEL“, there is the easy-to-install „LAMELLE“ for very homogeneous looking surfaces.

„LAMELLE“ – FIXED FORMAT WITH TONGUE+GROOVE CONNECTION



„PANEEL“ – VARIABLE ACCORDING TO CLIENTS REQUIREMENTS



Datasheet Nutform S6N2

VS_2022_7

S6N2-S



S6N2-B



S = Ridge width: 6,0mm
N = Groove width: 2,0mm

Open surface: 12,50%

Applicable for
→ Ceiling
→ Wall (outside the reach of hands)
→ Lay In

PRODUCT OPTIONS Acoustic boards from Trikustik are manufactured to order and in a wide range of variants.

- Perforation:** Front side : grooved
Back side: drilled (-B) or slotted holes (-S)
- Acoustic fleece:** black, laminated on back side
- Thickness:** 15-19mm depending on material / other thicknesses possible on request
- Edges:** as Format Paneel -> industrial cut
as Format Lamelle → lengthwise with tongue+groove connection
- Options:** Milling according to customer requirements

Formats: Lamelle (fix) + Paneel (variable)
Materials: MDF
Surfaces: many options depending on material
Fire Protection: many options depending on material

ONLINE - Product Range Overview

- available formats and measures
- available materials
- available surfaces and colors
- options regarding fire protection



All product options always up to date
via QR code scan or via this link → www.trikustik.at/sortiment

Application: Information on planning, processing, installation and care: www.trikustik.at

SOUND ABSORPTION VALUES

- Measurement:** acc. to DIN EN ISO 354
- Data source:** certificate by LGA/TÜV
- Valid for:** application at wall and ceiling
- Fleece:** SP50 or equivalent
- Insulation:** Sonorock or equivalent

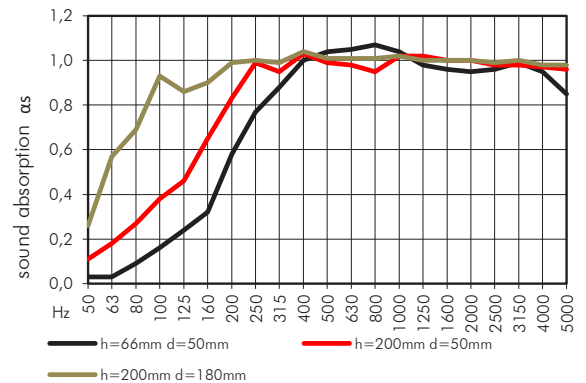
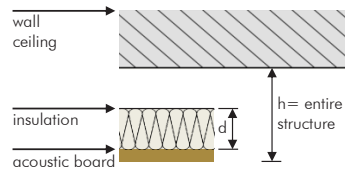

construction	Hz	50	63	80	100	125	160	200	250	315	400	500	630	800	1000	1250	1600	2000	2500	3150	4000	5000	
h=66mm d=50mm	α_s	0,03	0,03	0,09	0,16	0,24	0,32	0,58	0,77	0,88	1,00	1,04	1,05	1,07	1,04	0,98	0,96	0,95	0,96	0,99	0,95	0,85	α_w : 1,00
	α_p		0,05			0,25			0,75			1,00			1,00			0,95			0,95		SAA: 0,94
h=200mm d=50mm	α_s	0,11	0,18	0,27	0,38	0,46	0,65	0,83	0,99	0,95	1,03	0,99	0,98	0,95	1,02	1,02	1,00	1,00	0,98	0,98	0,97	0,96	α_w : 1,00
	α_p		0,20			0,50			0,90			1,00			1,00			1,00			0,95		SAA: 0,98
h=200mm d=180mm	α_s	0,26	0,57	0,69	0,93	0,86	0,90	0,99	1,00	0,99	1,04	1,01	1,01	1,01	1,02	1,00	1,00	1,00	0,99	1,00	0,98	0,98	α_w : 1,00
	α_p		0,50			0,90			1,00			1,00			1,00			1,00			1,00		SAA: 1,01

Datasheet Nutform S14N2

v5, 2022.7

S14N2-S



S14N2-B

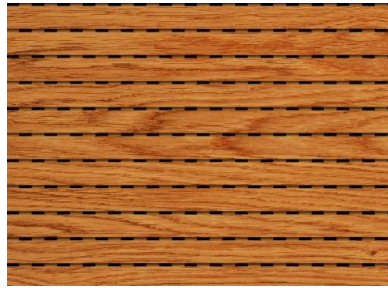

S = Ridge width: 14,0mm
N = Groove width: 2,0mm

Open surface: 6,25%

- Applicable for
- Ceiling
 - Wall
 - Cabinet door
 - Partitioning
 - Lay In

PRODUCT OPTIONS Acoustic boards from Trikustik are manufactured to order and in a wide range of variants.

Perforation: Front side : grooved
Back side: drilled (-B) or slotted holes (-S)

Acoustic fleece: black, laminated on back side

Thickness: 15-19mm depending on material / other thicknesses possible on request

Edges: as Format Paneel -> industrial cut
as Format Lamelle → lengthwise with tongue+groove connection

Options: Milling according to customer requirements

Formats: Lamelle (fix) + Paneel (variable)
Materials: MDF and many other materials
Surfaces: many options depending on material
Fire Protection: many options depending on material

ONLINE - Product Range Overview

- available formats and measures
- available materials
- available surfaces and colors
- options regarding fire protection



All product options always up to date
via QR code scan or via this link → www.trikustik.at/sortiment

Application: Information on planning, processing, installation and care: www.trikustik.at

SOUND ABSORPTION VALUES

Measurement: acc. to DIN EN ISO 354
Data source: certificate by LGA/TÜV
Valid for: application at wall and ceiling
Fleece: SP50 or equivalent
Insulation: Sonorock or equivalent

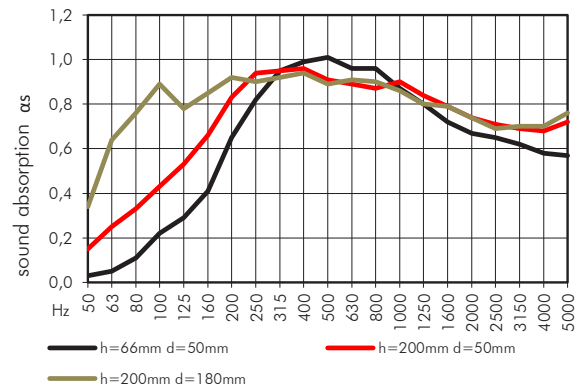
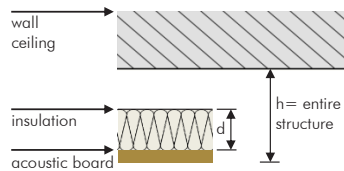

construction	Hz	50	63	80	100	125	160	200	250	315	400	500	630	800	1000	1250	1600	2000	2500	3150	4000	5000	
h=66mm d=50mm	α_s	0,03	0,05	0,11	0,22	0,29	0,41	0,65	0,82	0,95	0,99	1,01	0,96	0,96	0,87	0,80	0,72	0,67	0,65	0,62	0,58	0,57	α_w : 0,75(LM) SAA: 0,85
	α_p		0,05		0,30			0,80			1,00				0,90			0,70			0,60		
h=200mm d=50mm	α_s	0,15	0,25	0,33	0,43	0,53	0,66	0,83	0,94	0,95	0,96	0,91	0,89	0,87	0,90	0,84	0,79	0,74	0,71	0,69	0,68	0,72	α_w : 0,80(L) SAA: 0,85
	α_p		0,25		0,55			0,90			0,90				0,85			0,75			0,70		
h=200mm d=180mm	α_s	0,34	0,64	0,76	0,89	0,78	0,85	0,92	0,90	0,92	0,94	0,89	0,91	0,90	0,86	0,80	0,79	0,74	0,69	0,70	0,70	0,76	α_w : 0,80(L) SAA: 0,86
	α_p		0,60		0,85			0,90			0,90				0,85			0,75			0,70		

Datasheet Nutform S30N2

VS_2022_7

S30N2-S



S30N2-B (vormals S30N2-BG)



S = Ridge width: 30,0mm
N = Groove width: 2,0mm

Open surface: 3,13%

- Applicable for
- Ceiling
 - Wall
 - Cabinet door
 - Partitioning
 - Lay In

PRODUCT OPTIONS Acoustic boards from Trikustik are manufactured to order and in a wide range of variants.

Perforation: Front side : grooved
Back side: drilled (-B) or slotted holes (-S)

Acoustic fleece: black, laminated on back side

Thickness: 15-19mm depending on material / other thicknesses possible on request

Edges: as Format Paneel -> industrial cut
as Format Lamelle → lengthwise with tongue+groove connection

Options: Milling according to customer requirements

Formats: Lamelle (fix) + Paneel (variable)

Materials: MDF and many other materials

Surfaces: many options depending on material

Fire Protection: many options depending on material

ONLINE - Product Range Overview

→ available formats and measures

→ available materials

→ available surfaces and colors

→ options regarding fire protection



All product options always up to date
via QR code scan or via this link → www.trikustik.at/sortiment

Application: Information on planning, processing, installation and care: www.trikustik.at

SOUND ABSORPTION VALUES

Measurement: acc. to DIN EN ISO 354

Data source: certificate by LGA/TÜV

Valid for: application at wall and ceiling

Fleece: SP50 or equivalent

Insulation: Sonorock or equivalent

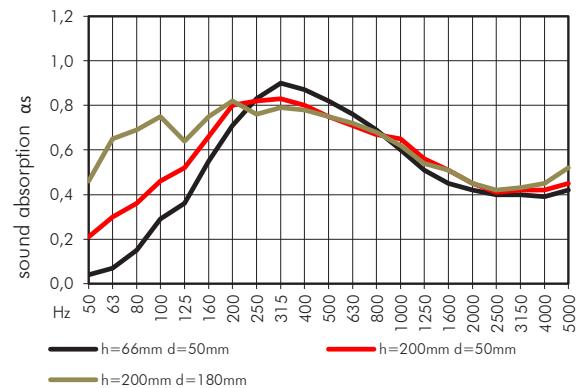
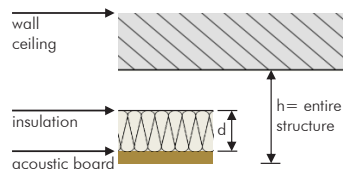

construction	Hz	50	63	80	100	125	160	200	250	315	400	500	630	800	1000	1250	1600	2000	2500	3150	4000	5000	
h=66mm d=50mm	α _s	0,04	0,07	0,15	0,29	0,36	0,55	0,71	0,83	0,90	0,87	0,82	0,76	0,69	0,60	0,51	0,45	0,42	0,40	0,40	0,39	0,42	α _w : 0,50(LM)
	α _p		0,10			0,40			0,80			0,80			0,60			0,40			0,40		SAA: 0,66
h=200mm d=50mm	α _s	0,21	0,30	0,36	0,46	0,52	0,66	0,80	0,82	0,83	0,80	0,75	0,71	0,67	0,65	0,56	0,51	0,45	0,41	0,42	0,42	0,45	α _w : 0,55(L)
	α _p		0,30			0,55			0,80			0,75			0,65			0,45			0,45		SAA: 0,66
h=200mm d=180mm	α _s	0,46	0,65	0,69	0,75	0,64	0,75	0,82	0,76	0,79	0,78	0,75	0,72	0,68	0,62	0,54	0,51	0,45	0,42	0,43	0,45	0,52	α _w : 0,55(L)
	α _p		0,60			0,70			0,80			0,75			0,60			0,45			0,45		SAA: 0,65

Datasheet Nutform S13N3

v5_2022_7

S13N3-S



S13N3-B

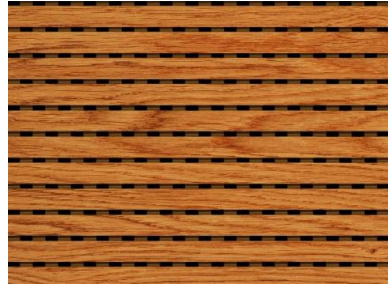

S = Ridge width: 13,0mm
N = Groove width: 3,0mm

Open surface: 9,38%

- Applicable for
- Ceiling
 - Wall
 - Cabinet door
 - Partitioning
 - Lay In

PRODUCT OPTIONS Acoustic boards from Trikustik are manufactured to order and in a wide range of variants.

Perforation: Front side : grooved
Back side: drilled (-B) or slotted holes (-S)

Acoustic fleece: black, laminated on back side

Thickness: 15-19mm depending on material / other thicknesses possible on request

Edges: as Format Paneel -> industrial cut
as Format Lamelle → lengthwise with tongue+groove connection

Options: Milling according to customer requirements

- Formats:** Lamelle (fix) + Paneel (variable)
- Materials:** MDF and many other materials
- Surfaces:** many options depending on material
- Fire Protection:** many options depending on material

ONLINE - Product Range Overview

- available formats and measures
- available materials
- available surfaces and colors
- options regarding fire protection



All product options always up to date
via QR code scan or via this link → www.trikustik.at/sortiment

Application: Information on planning, processing, installation and care: www.trikustik.at

SOUND ABSORPTION VALUES

- Measurement:** acc. to DIN EN ISO 354
- Data source:** certificate by LGA/TÜV
- Valid for:** application at wall and ceiling
- Fleece:** SP50 or equivalent
- Insulation:** Sonorock or equivalent

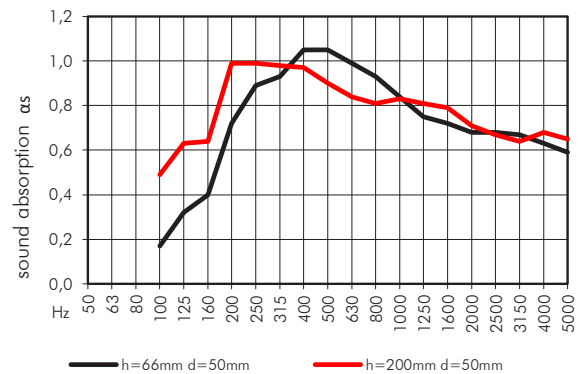
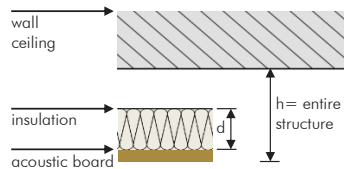

construction	Hz	50	63	80	100	125	160	200	250	315	400	500	630	800	1000	1250	1600	2000	2500	3150	4000	5000	
h=66mm d=50mm	α _s				0,17	0,32	0,40	0,72	0,89	0,93	1,05	1,05	0,99	0,93	0,84	0,75	0,72	0,68	0,68	0,67	0,63	0,59	α _w : 0,75(LM)
	α _p					0,30			0,85			1,05			0,85			0,70			0,65		SAA: 0,85
h=200mm d=50mm	α _s				0,49	0,63	0,64	0,99	0,99	0,98	0,97	0,90	0,84	0,81	0,83	0,81	0,79	0,71	0,67	0,64	0,68	0,65	α _w : 0,75(L)
	α _p					0,60			1,00			0,90			0,80			0,70			0,65		SAA: 0,86

Datasheet Nutform S45/29/13N3

VS_2022_7

S45/29/13N3-S



S45/29/13N3-B



S = Ridge width: 45/29/13mm
N = Groove width: 3,0mm

Open surface: 7,14%

- Applicable for
- Ceiling
 - Wall
 - Cabinet door
 - Partitioning
 - Lay In

PRODUCT OPTIONS Acoustic boards from Trikustik are manufactured to order and in a wide range of variants.

- Perforation:** Front side : grooved
Back side: drilled (-B) or slotted holes (-S)
- Acoustic fleece:** black, laminated on back side
- Thickness:** 15-19mm depending on material / other thicknesses possible on request
- Edges:** as Format Paneel -> industrial cut
as Format Lamelle → lengthwise with tongue+groove connection
- Options:** Milling according to customer requirements

- Formats:** Lamelle (fix) + Paneel (variable)
- Materials:** MDF and many other materials
- Surfaces:** many options depending on material
- Fire Protection:** many options depending on material

ONLINE - Product Range Overview

- available formats and measures
- available materials
- available surfaces and colors
- options regarding fire protection



All product options always up to date via QR code scan or via this link → www.trikustik.at/sortiment

Application: Information on planning, processing, installation and care: www.trikustik.at

SOUND ABSORPTION VALUES

- Measurement:** acc. to DIN EN ISO 354
- Data source:** certificate by LGA/TÜV
- Valid for:** application at wall and ceiling
- Fleece:** SP50 or equivalent
- Insulation:** Sonorock or equivalent

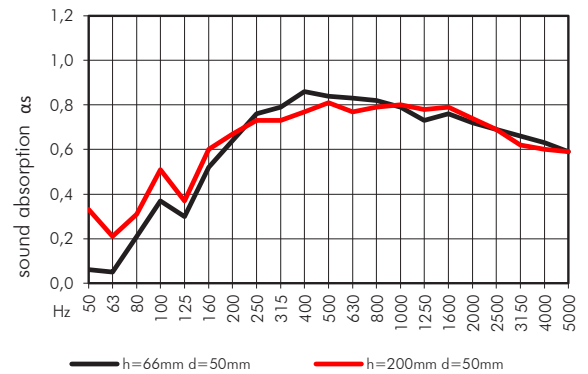
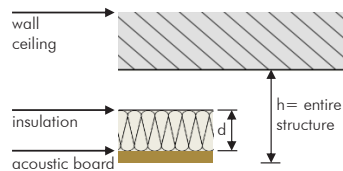

construction	Hz	50	63	80	100	125	160	200	250	315	400	500	630	800	1000	1250	1600	2000	2500	3150	4000	5000	
h=66mm d=50mm	α_s	0,06	0,05	0,21	0,37	0,30	0,52	0,64	0,76	0,79	0,86	0,84	0,83	0,82	0,79	0,73	0,76	0,72	0,69	0,66	0,63	0,59	α_w : 0,75
	α_p		0,10			0,40			0,75			0,85			0,80			0,70			0,65		SAA: 0,77
h=200mm d=50mm	α_s	0,33	0,21	0,31	0,51	0,37	0,60	0,67	0,73	0,73	0,77	0,81	0,77	0,79	0,80	0,78	0,79	0,74	0,69	0,62	0,60	0,59	α_w : 0,75
	α_p		0,30			0,50			0,70			0,80			0,80			0,75			0,60		SAA: 0,76

Datasheet Nutform S12N4

v5_2022.7

S12N4-S



S12N4-B



S = Ridge width: 12,0mm

N = Groove width: 4,0mm

Open surface: 12,50%

Applicable for

- Ceiling
- Wall
- Cabinet door
- Partitioning
- Lay In

PRODUCT OPTIONS Acoustic boards from Trikustik are manufactured to order and in a wide range of variants.

Perforation: Front side : grooved
Back side: drilled (-B) or slotted holes (-S)

Acoustic fleece: black, laminated on back side

Thickness: 15-19mm depending on material / other thicknesses possible on request

Edges: as Format Paneel -> industrial cut
as Format Lamelle → lengthwise with tongue+groove connection

Options: Milling according to customer requirements

Formats: Lamelle (fix) + Paneel (variable)

Materials: MDF and many other materials

Surfaces: many options depending on material

Fire Protection: many options depending on material

ONLINE - Product Range Overview

→ available formats and measures

→ available materials

→ available surfaces and colors

→ options regarding fire protection



All product options always up to date
via QR code scan or via this link → www.trikustik.at/sortiment

Application: Information on planning, processing, installation and care: www.trikustik.at

SOUND ABSORPTION VALUES

Measurement: acc. to DIN EN ISO 354

Data source: certificate by LGA/TÜV

Valid for: application at wall and ceiling

Fleece: SP50 or equivalent

Insulation: Sonorock or equivalent

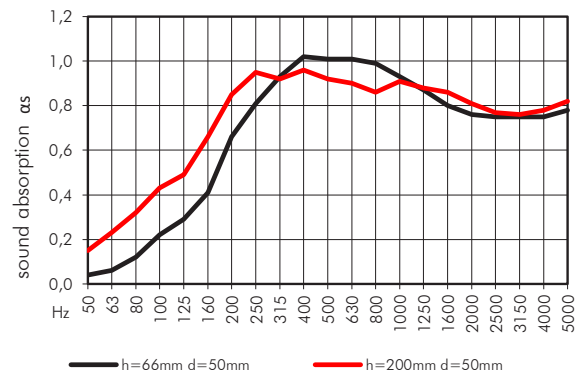
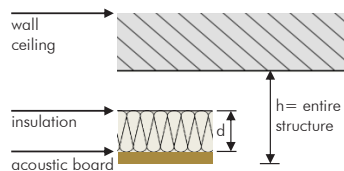

construction	Hz	50	63	80	100	125	160	200	250	315	400	500	630	800	1000	1250	1600	2000	2500	3150	4000	5000	
h=66mm d=50mm	α_s	0,04	0,06	0,12	0,22	0,29	0,41	0,66	0,81	0,93	1,02	1,01	1,01	0,99	0,93	0,87	0,80	0,76	0,75	0,75	0,75	0,78	α_w : 0,80
	α_p		0,05			0,30			0,80			1,00			0,95			0,75			0,75		SAA: 0,88
h=200mm d=50mm	α_s	0,15	0,23	0,32	0,43	0,49	0,66	0,85	0,95	0,92	0,96	0,92	0,90	0,86	0,91	0,88	0,86	0,81	0,77	0,76	0,78	0,82	α_w : 0,90
	α_p		0,25			0,55			0,90			0,95			0,90			0,80			0,80		SAA: 0,88

Datasheet Nutform S28N4

VS_2022_7

S28N4-S



S28N4-B (vormals S28N4-BG)

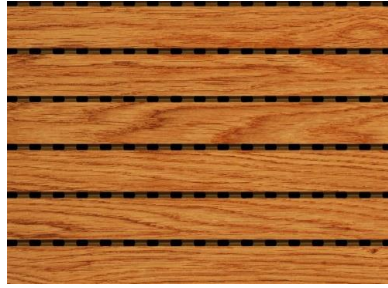

S = Ridge width: 28,0mm

N = Groove width: 4,0mm

Open surface: 6,25%

Applicable for

- Ceiling
- Wall
- Cabinet door
- Partitioning
- Lay In

PRODUCT OPTIONS Acoustic boards from Trikustik are manufactured to order and in a wide range of variants.

Perforation: Front side : grooved
Back side: drilled (-B) or slotted holes (-S)

Acoustic fleece: black, laminated on back side

Thickness: 15-19mm depending on material / other thicknesses possible on request

Edges: as Format Paneel -> industrial cut
as Format Lamelle → lengthwise with tongue+groove connection

Options: Milling according to customer requirements

Formats: Lamelle (fix) + Paneel (variable)

Materials: MDF and many other materials

Surfaces: many options depending on material

Fire Protection: many options depending on material

ONLINE - Product Range Overview

→ available formats and measures

→ available materials

→ available surfaces and colors

→ options regarding fire protection



All product options always up to date
via QR code scan or via this link → www.trikustik.at/sortiment

Application: Information on planning, processing, installation and care: www.trikustik.at

SOUND ABSORPTION VALUES

Measurement: acc. to DIN EN ISO 354

Data source: certificate by LGA/TÜV

Valid for: application at wall and ceiling

Fleece: SP50 or equivalent

Insulation: Sonorock or equivalent

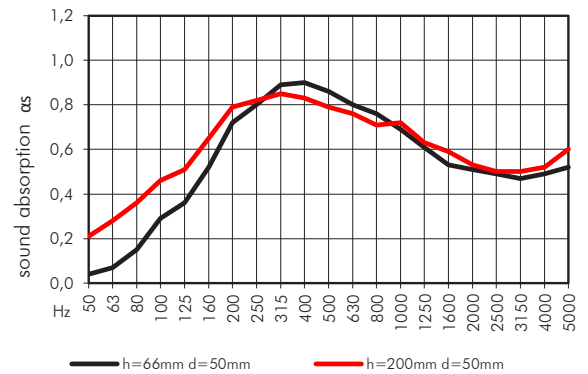
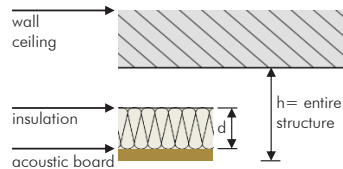

construction	Hz	50	63	80	100	125	160	200	250	315	400	500	630	800	1000	1250	1600	2000	2500	3150	4000	5000	
h=66mm d=50mm	α _s	0,04	0,07	0,15	0,29	0,36	0,52	0,72	0,80	0,89	0,90	0,86	0,80	0,76	0,69	0,61	0,53	0,51	0,49	0,47	0,49	0,52	α _w : 0,60 (LM)
	α _p		0,10		0,40			0,80			0,85			0,70			0,50				0,50		SAA: 0,71
h=200mm d=50mm	α _s	0,21	0,28	0,36	0,46	0,51	0,65	0,79	0,82	0,85	0,83	0,79	0,76	0,71	0,72	0,63	0,59	0,53	0,50	0,50	0,52	0,60	α _w : 0,65 (LM)
	α _p		0,30			0,55			0,80			0,80			0,70			0,55			0,55		SAA: 0,71

Datasheet Nutform S24N8

v5_2023.1

S24N8-B



S = Ridge width: 24,0mm
N = Groove width: 8,0mm

Open surface: 15,63%

- Applicable for
- Ceiling
 - Wall
 - Cabinet door
 - Partitioning
 - Lay In

PRODUCT OPTIONS Acoustic boards from Trikustik are manufactured to order and in a wide range of variants.

Perforation: Front side : grooved
Back side: drilled (-B)

Acoustic fleece: black, laminated on back side

Thickness: 15-19mm depending on material / other thicknesses possible on request

Edges: as Format Paneel -> industrial cut
as Format Lamelle → lengthwise with tongue+groove connection

Options: Milling according to customer requirements

Formats: Lamelle (fix) + Paneel (variable)
Materials: various option with black MDF core
Surfaces: many options depending on material
Fire Protection: many options depending on material

ONLINE - Product Range Overview

→ available formats and measures

→ available materials

→ available surfaces and colors

→ options regarding fire protection



All product options always up to date
via QR code scan or via this link → www.trikustik.at/sortiment

Application: Information on planning, processing, installation and care: www.trikustik.at

SOUND ABSORPTION VALUES

Measurement: acc. to DIN EN ISO 354

Data source: certificate by TU Graz

Valid for: application at wall and ceiling

Fleece: SP50 or equivalent

Insulation: Sonorock or equivalent

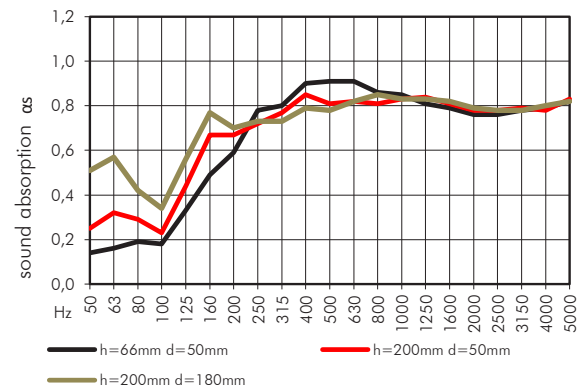
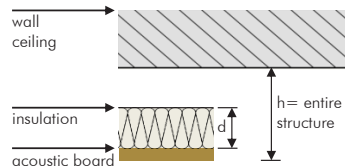

construction	Hz	50	63	80	100	125	160	200	250	315	400	500	630	800	1000	1250	1600	2000	2500	3150	4000	5000	
h=66mm d=50mm	α_s	0,14	0,16	0,19	0,18	0,33	0,49	0,59	0,78	0,80	0,90	0,91	0,91	0,86	0,85	0,81	0,79	0,76	0,76	0,78	0,79	0,82	α_w : 0,85
	α_p		0,15			0,35			0,70			0,90			0,85			0,75			0,80		SAA: 0,81
h=200mm d=50mm	α_s	0,25	0,32	0,29	0,23	0,44	0,67	0,67	0,72	0,77	0,85	0,81	0,82	0,81	0,83	0,84	0,81	0,78	0,78	0,79	0,78	0,83	α_w : 0,85
	α_p		0,30			0,45			0,70			0,85			0,85			0,80			0,80		SAA: 0,79
h=200mm d=180mm	α_s	0,51	0,57	0,42	0,34	0,56	0,77	0,70	0,73	0,73	0,79	0,78	0,82	0,85	0,83	0,83	0,82	0,79	0,78	0,78	0,80	0,82	α_w : 0,85
	α_p		0,50			0,55			0,70			0,80			0,85			0,80			0,80		SAA: 0,79

Datasheet Nutform S56N8

v5_2023_1

S56N8-B



S = Ridge width: 56,0mm
N = Groove width: 8,0mm

Open surface: 7,81%

- Applicable for
- Ceiling
 - Wall
 - Cabinet door
 - Partitioning
 - Lay In

PRODUCT OPTIONS Acoustic boards from Trikustik are manufactured to order and in a wide range of variants.

- Perforation:** Front side : grooved
Back side: drilled (-B)
- Acoustic fleece:** black, laminated on back side
- Thickness:** 15-19mm depending on material / other thicknesses possible on request
- Edges:** as Format Paneel -> industrial cut
as Format Lamelle → lengthwise with tongue+groove connection
- Options:** Milling according to customer requirements

- Formats:** Lamelle (fix) + Paneel (variable)
- Materials:** various option with black MDF core
- Surfaces:** many options depending on material
- Fire Protection:** many options depending on material

ONLINE - Product Range Overview
 → available formats and measures
 → available materials
 → available surfaces and colors
 → options regarding fire protection



All product options always up to date
via QR code scan or via this link → www.trikustik.at/sortiment

Application: Information on planning, processing, installation and care: www.trikustik.at

SOUND ABSORPTION VALUES

- Measurement:** acc. to DIN EN ISO 354
- Data source:** certificate by TU Graz
- Valid for:** application at wall and ceiling
- Fleece:** SP50 or equivalent
- Insulation:** Sonorock or equivalent

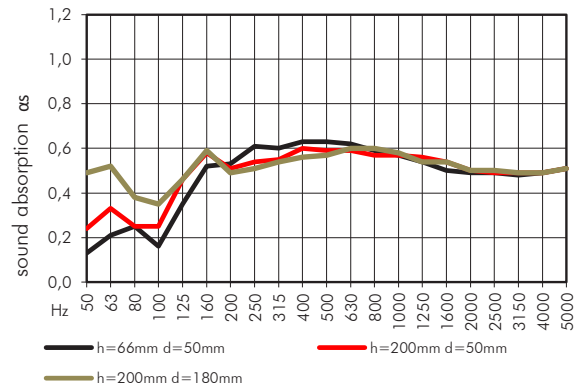
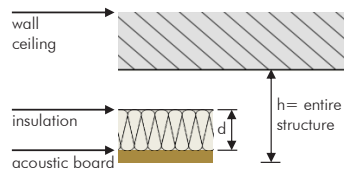

construction	Hz	50	63	80	100	125	160	200	250	315	400	500	630	800	1000	1250	1600	2000	2500	3150	4000	5000	
h=66mm d=50mm	α_s	0,13	0,21	0,25	0,16	0,35	0,52	0,53	0,61	0,60	0,63	0,63	0,62	0,59	0,57	0,54	0,50	0,49	0,49	0,48	0,49	0,51	α_w : 0,55 (L)
	α_p		0,20			0,35			0,60			0,65			0,55			0,50			0,50		SAA: 0,57
h=200mm d=50mm	α_s	0,24	0,33	0,25	0,25	0,46	0,58	0,51	0,54	0,55	0,60	0,59	0,59	0,57	0,57	0,56	0,54	0,50	0,49	0,49	0,49	0,51	α_w : 0,55
	α_p		0,25			0,45			0,55			0,60			0,55			0,50			0,50		SAA: 0,55
h=200mm d=180mm	α_s	0,49	0,52	0,38	0,35	0,46	0,59	0,49	0,51	0,54	0,56	0,57	0,60	0,60	0,58	0,54	0,54	0,50	0,50	0,49	0,49	0,51	α_w : 0,55
	α_p		0,45			0,45			0,50			0,60			0,55			0,50			0,50		SAA: 0,54

Datasheet Nutform for Cabinet doors

VS_2022_7

S14N2-B



R = Grid in mm: 14,0mm
D = Diameter in mm: 2,0mm

Open surface: 6,25%

Applicable for
→ Cabinet door

PRODUCT OPTIONS Acoustic boards from Trikustik are manufactured to order and in a wide range of variants.

- Perforation:** Front side : grooved
Back side: drilled (-B) or slotted holes (-S)
- Acoustic fleece:** black, laminated on back side
- Thickness:** 15-19mm depending on material / other thicknesses possible on request

Options: Milling according to customer requirements

Application: Information on planning, processing, installation and care: www.trikustik.at

SOUND ABSORPTION VALUES

- Measurement:** acc. to DIN EN ISO 354
- Data source:** Zertifikat LGA/TÜV
- Valid for:** cabinet doors
- Fleece:** SP50 or equivalent
- Insulation:** 80% filled with books and files

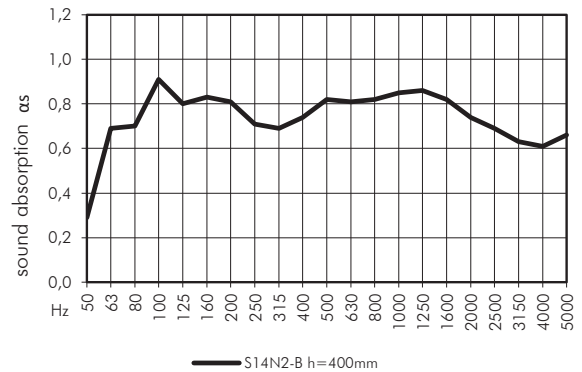
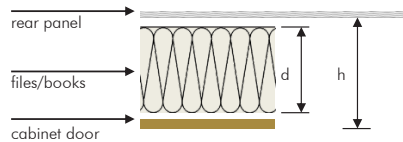

construction	Hz	50	63	80	100	125	160	200	250	315	400	500	630	800	1000	1250	1600	2000	2500	3150	4000	5000	
S14N2-B h=400mm	α_s	0,29	0,69	0,70	0,91	0,80	0,83	0,81	0,71	0,69	0,74	0,82	0,81	0,82	0,85	0,86	0,82	0,74	0,69	0,63	0,61	0,66	α_w : 0,80
	α_p		0,55			0,85			0,75		0,80			0,85			0,75				0,65		SAA: 0,78

REFERENCES

Lecture halls, auditoriums and universities

Österreichisches Parlament / BOKU Wien / JKU Linz /
IST Austria / Uni Wien / FH Hagenberg /...

Schools and kindergartens

Bildungszentrum Reith / Tourismusschule St. Johann / KIGA Bad
Sauerbrunn / VS Brunn /...

Concert and lecture halls

Stadthalle Wien / Landestheater Linz / Festspiele Bregenz /...

Music rehearsal rooms

Future Art Lab / Synchron Stage Vienna / Wiener Sängerknaben
/ Hofburg / Tonstudio ORF /...

Sports halls, gymnasiums and exercise rooms

Multiversum Schwechat / Sportpark Lissfeld /
Turnsaal Michelhausen /...

Office and meeting areas

Europäisches Parlament_Strassburg / mysugr / KPMG / Engel
GmbH / Erber Group /...

Gastronomy and commerce

The Eagle_Kreischberg / SCS / Kurhotel Bad Zell / Weingut
Högl /...

Trikustik GesmbH
Ritterkamp 8
3911 Rappottenstein
office@trikustik.at



www.trikustik.at