



LOCH FORM

trikustik 

www.trikustik.at

trikustik3

THE WORLD IS SOUND.

Joachim Ernst Berendt

TRIKUSTIK is an innovative Austrian company specialising in the development and manufacturing of high-quality acoustic boards made of solid wood and wood-based materials.

Through this focus on products for room acoustic optimisation, we offer building owners, acoustic planners, architects and processors many years of expertise in the development of individual solutions and a high variance of standardised design options.

As a team, we deliberately break new ground and develop ourselves according to the principles of self-organisation.

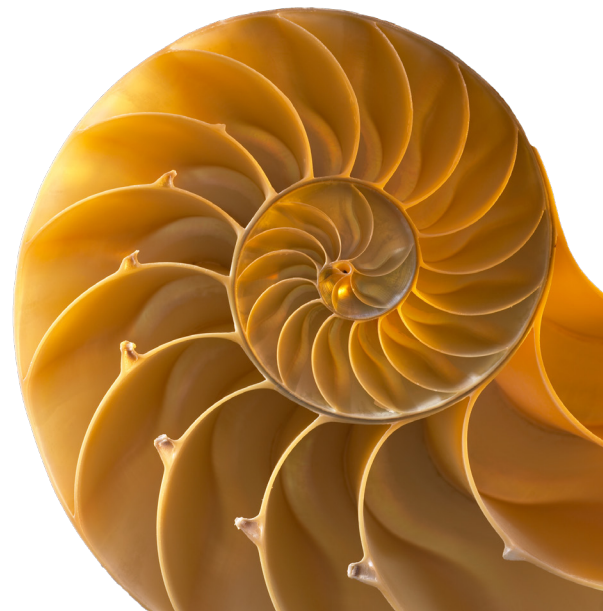

LOCH FORM

ACOUSTIC BOARDS

Acoustic panels with punched perforations are very versatile and can be manufactured with various hole diameters and grids. Due to the order-related production, hole-free edges as well as cut-outs can be made to customer requirements.

More reference photos on www.trikustik.at

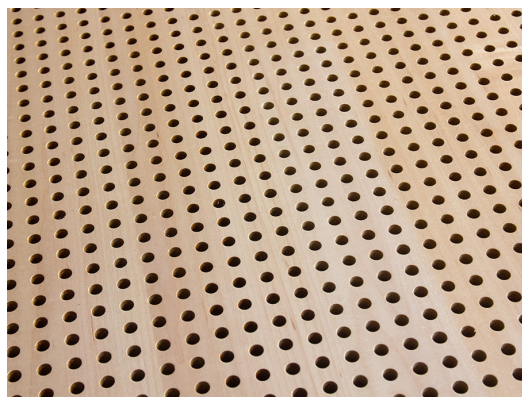
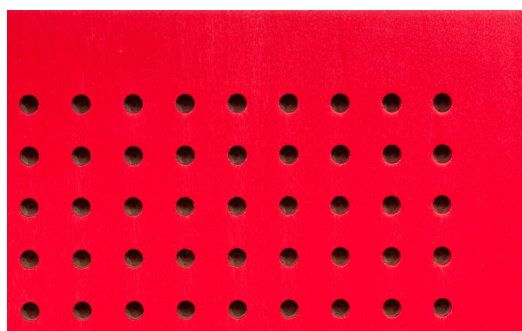
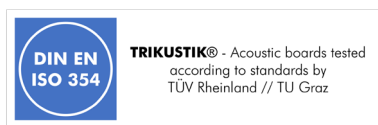

Datasheet Lochform R6,4D3

v5_2022_7

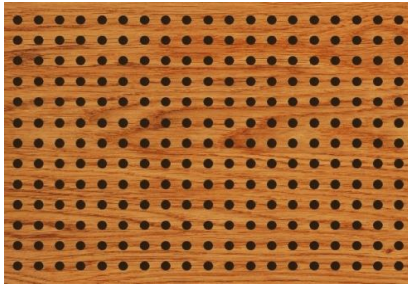

R = Grid in mm: 6,4mm
D = Diameter in mm: 3,0mm

Open surface: 17,26%

- Applicable for
- Ceiling
 - Wall
 - Cabinet door
 - Partitioning
 - Lay In

PRODUCT OPTIONS Acoustic boards from Trikustik are manufactured to order and in a wide range of variants.

Perforation: Front side : drilled (through hole)

Acoustic fleece: black, laminated on back side

Thickness: 15-19mm depending on material / other thicknesses possible on request

Edges: as Format Paneel -> industrial cut

Options: unperforated friezes according to customer requirements

- Formats:** Paneel (variable)
- Materials:** MDF and many other materials
- Surfaces:** many options depending on material
- Fire Protection:** many options depending on material

ONLINE - Product Range Overview

- available formats and measures
- available materials
- available surfaces and colors
- options regarding fire protection



All product options always up to date via QR code scan or via this link → www.trikustik.at/sortiment

Application: Information on planning, processing, installation and care: www.trikustik.at

SOUND ABSORPTION VALUES

Measurement: acc. to DIN EN ISO 354

Data source: certificate by LGA/TÜV

Valid for: application at wall and ceiling

Fleece: SP50 or equivalent

Insulation: Sonorock or equivalent

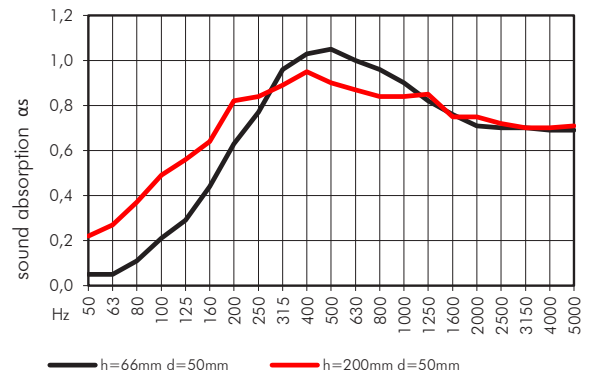
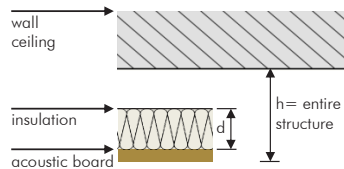

construction	Hz	50	63	80	100	125	160	200	250	315	400	500	630	800	1000	1250	1600	2000	2500	3150	4000	5000	
h=66mm d=50mm	α_s	0,05	0,05	0,11	0,21	0,29	0,44	0,63	0,77	0,96	1,03	1,05	1,00	0,96	0,90	0,82	0,76	0,71	0,70	0,70	0,69	0,69	α_w : 0,80
	α_p		0,05		0,30			0,80			1,05			0,90			0,70				0,70		SAA: 0,86
h=200mm d=50mm	α_s	0,22	0,27	0,37	0,49	0,56	0,64	0,82	0,84	0,89	0,95	0,90	0,87	0,84	0,84	0,85	0,75	0,75	0,72	0,70	0,70	0,71	α_w : 0,80 (L)
	α_p		0,30			0,55			0,85			0,90			0,85		0,75				0,70		SAA: 0,84

Datasheet Lochform R8D3

VS_2022_7

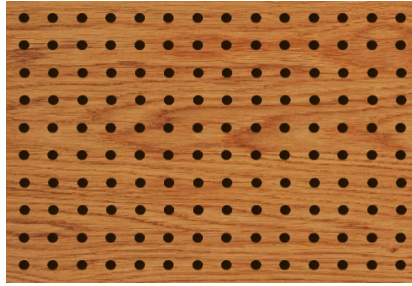

R = Grid in mm: 8,0mm
D = Diameter in mm: 3,0mm

Open surface: 11,04%

- Applicable for
- Ceiling
 - Wall
 - Cabinet door
 - Partitioning
 - Lay In

PRODUCT OPTIONS Acoustic boards from Trikustik are manufactured to order and in a wide range of variants.

Perforation: Front side: drilled (through hole)

Acoustic fleece: black, laminated on back side

Thickness: 15-19mm depending on material / other thicknesses possible on request

Edges: as Format Panel -> industrial cut

Options: unperforated friezes according to customer requirements

Formats: Panel (variable)
Materials: MDF and many other materials
Surfaces: many options depending on material
Fire Protection: many options depending on material

ONLINE - Product Range Overview

→ available formats and measures

→ available materials

→ available surfaces and colors

→ options regarding fire protection



All product options always up to date
via QR code scan or via this link → www.trikustik.at/sortiment

Application: Information on planning, processing, installation and care: www.trikustik.at

SOUND ABSORPTION VALUES

Measurement: acc. to DIN EN ISO 354

Data source: certificate by LGA/TÜV

Valid for: application at wall and ceiling

Fleece: SP50 or equivalent

Insulation: Sonorock or equivalent

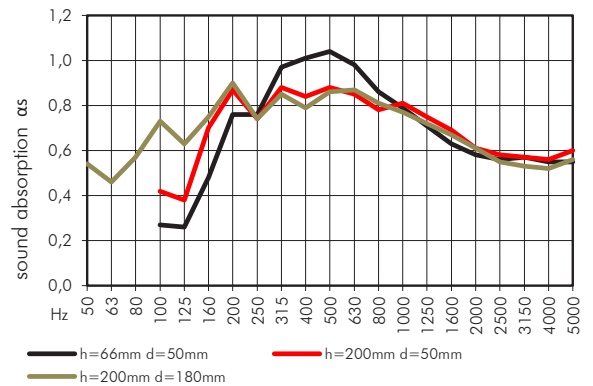
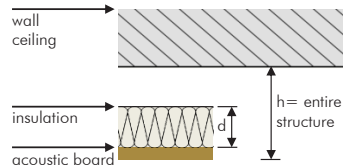

construction	Hz	50	63	80	100	125	160	200	250	315	400	500	630	800	1000	1250	1600	2000	2500	3150	4000	5000	
h=66mm d=50mm	α_s				0,27	0,26	0,48	0,76	0,76	0,97	1,01	1,04	0,98	0,86	0,79	0,71	0,63	0,58	0,56	0,57	0,55	0,55	α_w : 0,65 (M)
	α_p					0,35			0,85			1,00			0,80			0,60			0,55		SAA: 0,80
h=200mm d=50mm	α_s				0,42	0,38	0,70	0,87	0,74	0,88	0,84	0,88	0,85	0,78	0,81	0,75	0,69	0,61	0,58	0,57	0,56	0,60	α_w : 0,70 (L)
	α_p					0,50			0,85		0,85			0,80				0,65			0,60		SAA: 0,77
h=200mm d=180mm	α_s	0,54	0,46	0,57	0,73	0,63	0,75	0,90	0,74	0,85	0,79	0,86	0,87	0,81	0,77	0,72	0,67	0,61	0,55	0,53	0,52	0,56	α_w : 0,65 (L)
	α_p		0,50						0,85			0,85			0,75				0,60			0,55	SAA: 0,76

Datasheet Lochform R8D4

v5_2022_7

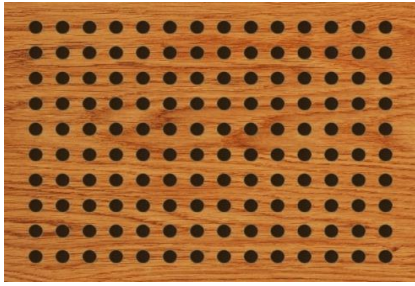

R = Grid in mm: 8,0mm
D = Diameter in mm: 4,0mm

Open surface: 19,63%

- Applicable for
- Ceiling
 - Wall
 - Cabinet door
 - Partitioning
 - Lay In

PRODUCT OPTIONS Acoustic boards from Trikustik are manufactured to order and in a wide range of variants.

Perforation: Front side: drilled (through hole)

Acoustic fleece: black, laminated on back side

Thickness: 15-19mm depending on material / other thicknesses possible on request

Edges: as Format Paneel -> industrial cut

Options: unperforated friezes according to customer requirements

- Formats:** Panel (variable)
- Materials:** MDF and many other materials
- Surfaces:** many options depending on material
- Fire Protection:** many options depending on material

ONLINE - Product Range Overview

- available formats and measures
- available materials
- available surfaces and colors
- options regarding fire protection



All product options always up to date via QR code scan or via this link → www.trikustik.at/sortiment

Application: Information on planning, processing, installation and care: www.trikustik.at

SOUND ABSORPTION VALUES

Measurement: acc. to DIN EN ISO 354

Data source: certificate by LGA/TÜV

Valid for: application at wall and ceiling

Fleece: SP50 or equivalent

Insulation: Sonorock or equivalent

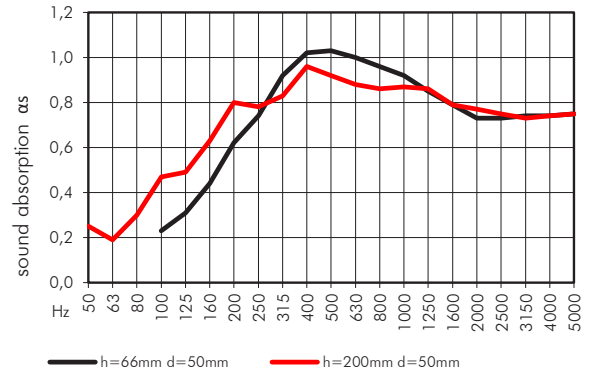
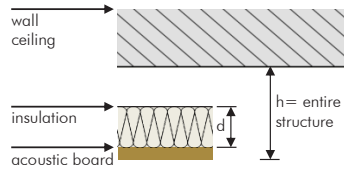

construction	Hz	50	63	80	100	125	160	200	250	315	400	500	630	800	1000	1250	1600	2000	2500	3150	4000	5000	
h=66mm d=50mm	alpha_s				0,23	0,31	0,44	0,62	0,74	0,92	1,02	1,03	1,00	0,96	0,92	0,85	0,79	0,73	0,73	0,74	0,74	0,75	alpha_w: 0,85
	alpha_p					0,35			0,75			1,00			0,90			0,75			0,75		SAA: 0,86
h=200mm d=50mm	alpha_s	0,25	0,19	0,30	0,47	0,49	0,63	0,80	0,78	0,83	0,96	0,92	0,88	0,86	0,87	0,86	0,79	0,77	0,75	0,73	0,74	0,75	alpha_w: 0,85
	alpha_p		0,25			0,55			0,80			0,90			0,85			0,75			0,75		SAA: 0,84

Datasheet Lochform R16D6

VS_2022_7

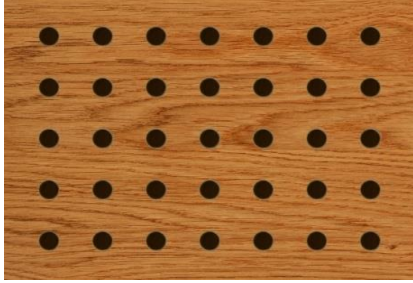

R = Grid in mm: 16,0mm
D = Diameter in mm: 6,0mm

Open surface: 11,04%

- Applicable for
- Ceiling
 - Wall
 - Cabinet door
 - Partitioning
 - Lay In

PRODUCT OPTIONS Acoustic boards from Trikustik are manufactured to order and in a wide range of variants.

Perforation: Front side: drilled (through hole)

Acoustic fleece: black, laminated on back side

Thickness: 15-19mm depending on material / other thicknesses possible on request

Edges: as Format Paneel -> industrial cut

Options: unperforated friezes according to customer requirements

- Formats:** Paneel (variable)
- Materials:** MDF and many other materials
- Surfaces:** many options depending on material
- Fire Protection:** many options depending on material

ONLINE - Product Range Overview

- available formats and measures
- available materials
- available surfaces and colors
- options regarding fire protection



All product options always up to date via QR code scan or via this link → www.trikustik.at/sortiment

Application: Information on planning, processing, installation and care: www.trikustik.at

SOUND ABSORPTION VALUES

Measurement: acc. to DIN EN ISO 354

Data source: certificate by LGA/TÜV

Valid for: application at wall and ceiling

Fleece: SP50 or equivalent

Insulation: Sonorock or equivalent

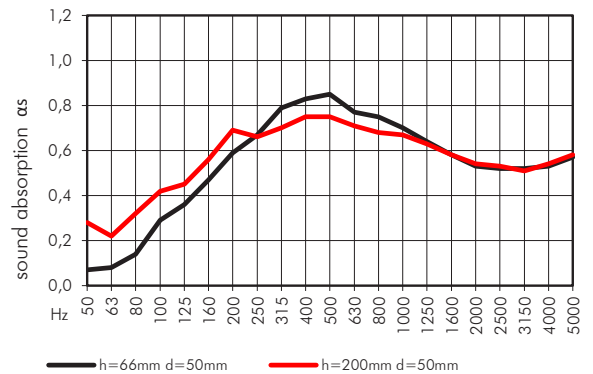
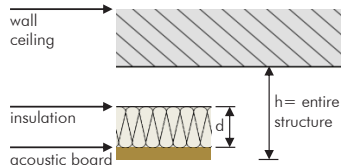

construction	Hz	50	63	80	100	125	160	200	250	315	400	500	630	800	1000	1250	1600	2000	2500	3150	4000	5000	
h=66mm d=50mm	α_s	0,07	0,08	0,14	0,29	0,36	0,47	0,59	0,67	0,79	0,83	0,85	0,77	0,75	0,70	0,64	0,58	0,53	0,52	0,52	0,53	0,57	α_w : 0,65 (L)
	α_p		0,10			0,35			0,70			0,80			0,70			0,55			0,55		SAA: 0,68
h=200mm d=50mm	α_s	0,28	0,22	0,32	0,42	0,45	0,56	0,69	0,66	0,70	0,75	0,75	0,71	0,68	0,67	0,63	0,58	0,54	0,53	0,51	0,54	0,58	α_w : 0,65 (L)
	α_p		0,25			0,50			0,70			0,75			0,65			0,55			0,55		SAA: 0,66

Datasheet Lochform R16D8

v5_2022_7

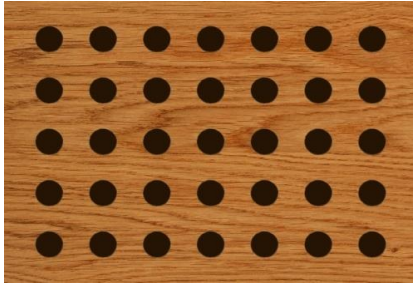

R = Grid in mm: 16,0mm
D = Diameter in mm: 8,0mm

Open surface: 19,63%

- Applicable for
- Ceiling
 - Wall
 - Cabinet door
 - Partitioning
 - Lay In

PRODUCT OPTIONS Acoustic boards from Trikustik are manufactured to order and in a wide range of variants.

Perforation: Front side: drilled (through hole)

Acoustic fleece: black, laminated on back side

Thickness: 15-19mm depending on material / other thicknesses possible on request

Edges: as Format Paneel -> industrial cut

Options: unperforated friezes according to customer requirements

- Formats:** Panel (variable)
- Materials:** MDF and many other materials
- Surfaces:** many options depending on material
- Fire Protection:** many options depending on material

ONLINE - Product Range Overview

→ available formats and measures

→ available materials

→ available surfaces and colors

→ options regarding fire protection



All product options always up to date via QR code scan or via this link → www.trikustik.at/sortiment

Application: Information on planning, processing, installation and care: www.trikustik.at

SOUND ABSORPTION VALUES

Measurement: acc. to DIN EN ISO 354

Data source: certificate by LGA/TÜV

Valid for: application at wall and ceiling

Fleece: SP50 or equivalent

Insulation: Sonorock or equivalent

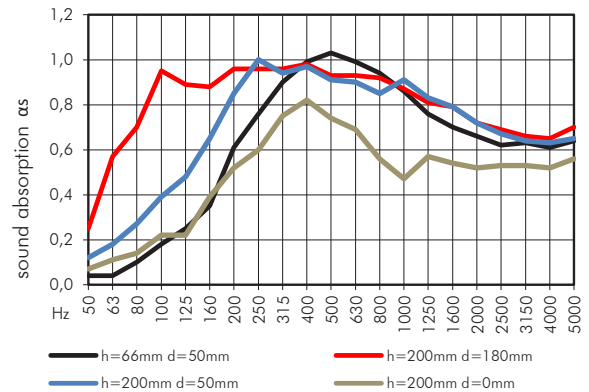
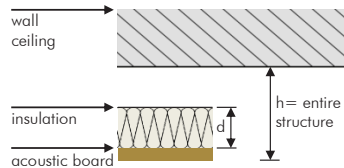

construction	Hz	50	63	80	100	125	160	200	250	315	400	500	630	800	1000	1250	1600	2000	2500	3150	4000	5000	
h=66mm d=50mm	α_s	0,04	0,04	0,10	0,18	0,25	0,35	0,61	0,76	0,90	0,99	1,03	0,99	0,94	0,86	0,76	0,70	0,66	0,62	0,63	0,61	0,64	α_w : 0,75 (M) SAA: 0,82
	α_p		0,05			0,25			0,75			1,00			0,85			0,65			0,65		
h=200mm d=50mm	α_s	0,12	0,18	0,27	0,39	0,48	0,65	0,85	1,00	0,94	0,97	0,91	0,90	0,85	0,91	0,83	0,79	0,72	0,67	0,64	0,63	0,65	α_w : 0,80 (L) SAA: 0,86
	α_p		0,20			0,50			0,95			0,95			0,85			0,75			0,65		
h=200mm d=0mm	α_s	0,07	0,11	0,14	0,22	0,22	0,39	0,52	0,60	0,75	0,82	0,74	0,69	0,56	0,47	0,57	0,54	0,52	0,53	0,53	0,52	0,56	α_w : 0,60 SAA: 0,61
	α_p		0,10			0,30			0,60			0,75			0,55			0,55			0,55		
h=200mm d=180mm	α_s	0,25	0,57	0,70	0,95	0,89	0,88	0,96	0,96	0,96	0,98	0,93	0,93	0,92	0,87	0,81	0,79	0,72	0,69	0,66	0,65	0,70	α_w : 0,75 (L) SAA: 0,87
	α_p		0,50			0,90			0,95			0,95			0,85			0,75			0,65		

Datasheet Lochform R16D10

VS_2022_7

R = Grid in mm: 16,0mm

D = Diameter in mm: 10,0mm

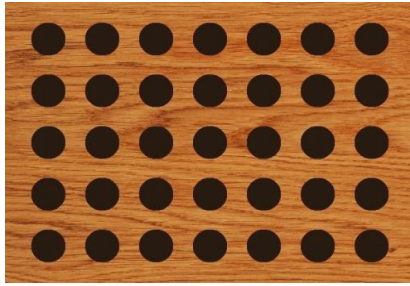

Open surface: 30,68%

Applicable for

- Ceiling
- Wall
- Cabinet door
- Partitioning
- Lay In

PRODUCT OPTIONS Acoustic boards from Trikustik are manufactured to order and in a wide range of variants.

Perforation: Front side: drilled (through hole)

Acoustic fleece: black, laminated on back side

Thickness: 15-19mm depending on material / other thicknesses possible on request

Edges: as Format Panel -> industrial cut

Options: unperforated friezes according to customer requirements

Formats: Panel (variable)

Materials: MDF and many other materials

Surfaces: many options depending on material

Fire Protection: many options depending on material

ONLINE - Product Range Overview

→ available formats and measures

→ available materials

→ available surfaces and colors

→ options regarding fire protection



All product options always up to date

via QR code scan or via this link → www.trikustik.at/sortiment

Application: Information on planning, processing, installation and care: www.trikustik.at

SOUND ABSORPTION VALUES

Measurement: acc. to DIN EN ISO 354

Data source: certificate by TGM

Valid for: application at wall and ceiling

Fleece: SP50 or equivalent

Insulation: Sonorock or equivalent

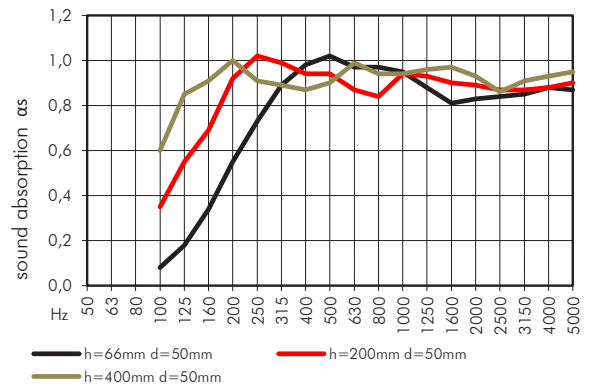
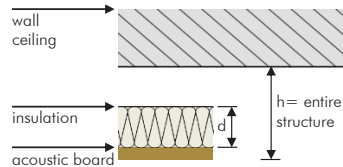

construction	Hz	50	63	80	100	125	160	200	250	315	400	500	630	800	1000	1250	1600	2000	2500	3150	4000	5000	
h=66mm d=50mm	α_s				0,08	0,18	0,34	0,55	0,73	0,89	0,98	1,02	0,97	0,97	0,95	0,88	0,81	0,83	0,84	0,85	0,88	0,87	α_w : 0,90
	α_p					0,20			0,70			1,00			0,95			0,85			0,85		SAA: 0,87
h=200mm d=50mm	α_s				0,35	0,55	0,69	0,92	1,02	0,99	0,94	0,94	0,87	0,84	0,94	0,93	0,90	0,89	0,87	0,87	0,88	0,90	α_w : 0,90 (L)
	α_p					0,55			1,00			0,90			0,90			0,90			0,90		SAA: 0,92
h=400mm d=50mm	α_s				0,60	0,85	0,91	1,00	0,91	0,89	0,87	0,90	0,99	0,94	0,94	0,96	0,97	0,93	0,86	0,91	0,93	0,95	α_w : 0,95
	α_p					0,80			0,95			0,90			0,95			0,90			0,95		SAA: 0,93

Datasheet Lochform R32D8

VS_2022_7

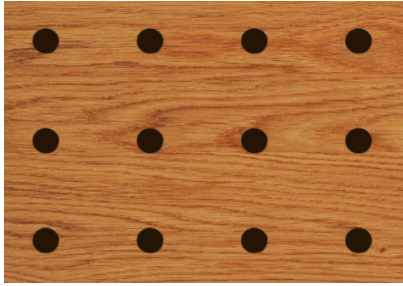

R = Grid in mm: 32,0mm
D = Diameter in mm: 8,0mm

Open surface: 4,91%

- Applicable for
- Ceiling
 - Wall
 - Cabinet door
 - Partitioning
 - Lay In

PRODUCT OPTIONS Acoustic boards from Trikustik are manufactured to order and in a wide range of variants.

Perforation: Front side: drilled (through hole)

Acoustic fleece: black, laminated on back side

Thickness: 15-19mm depending on material / other thicknesses possible on request

Edges: as Format Panel -> industrial cut

Options: unperforated friezes according to customer requirements

- Formats:** Panel (variable)
- Materials:** MDF and many other materials
- Surfaces:** many options depending on material
- Fire Protection:** many options depending on material

ONLINE - Product Range Overview

→ available formats and measures

→ available materials

→ available surfaces and colors

→ options regarding fire protection



All product options always up to date via QR code scan or via this link → www.trikustik.at/sortiment

Application: Information on planning, processing, installation and care: www.trikustik.at

SOUND ABSORPTION VALUES

Measurement: acc. to DIN EN ISO 354

Data source: certificate by LGA/TÜV

Valid for: application at wall and ceiling

Fleece: SP50 or equivalent

Insulation: Sonorock or equivalent

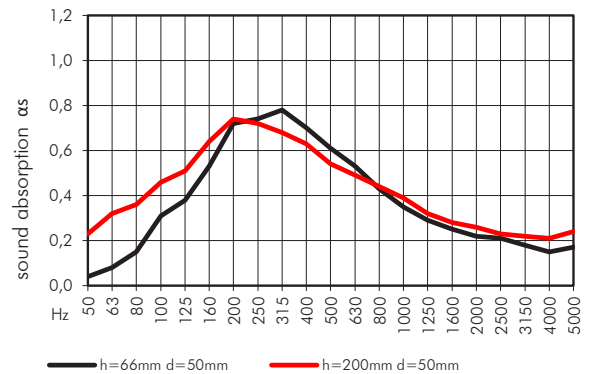
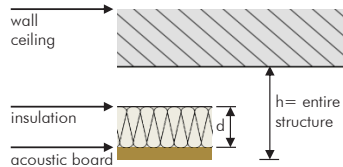

construction	Hz	50	63	80	100	125	160	200	250	315	400	500	630	800	1000	1250	1600	2000	2500	3150	4000	5000	
h=66mm d=50mm	α_s	0,04	0,08	0,15	0,31	0,38	0,53	0,72	0,74	0,78	0,70	0,61	0,53	0,43	0,35	0,29	0,25	0,22	0,21	0,18	0,15	0,17	α_w : 0,30 (LM) SAA: 0,48
	α_p		0,10			0,40			0,75			0,60			0,35			0,25			0,15		
h=200mm d=50mm	α_s	0,23	0,32	0,36	0,46	0,51	0,64	0,74	0,72	0,68	0,63	0,54	0,49	0,44	0,39	0,32	0,28	0,26	0,23	0,22	0,21	0,24	α_w : 0,30 (LM) SAA: 0,47
	α_p		0,30			0,55			0,70			0,55			0,40			0,25			0,20		

Datasheet Lochform R32D12

VS_2022_7

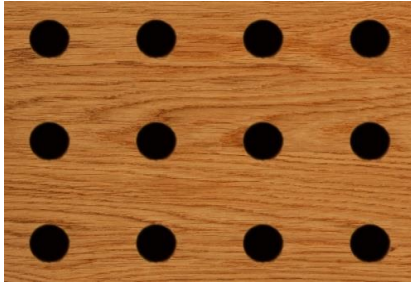

R = Grid in mm: 32,0mm
D = Diameter in mm: 12,0mm

Open surface: 11,04%

- Applicable for
- Ceiling
 - Wall
 - Cabinet door
 - Partitioning
 - Lay In

PRODUCT OPTIONS Acoustic boards from Trikustik are manufactured to order and in a wide range of variants.

Perforation: Front side: drilled (through hole)

Acoustic fleece: black, laminated on back side

Thickness: 15-19mm depending on material / other thicknesses possible on request

Edges: as Format Paneel -> industrial cut

Options: unperforated friezes according to customer requirements

Formats: Paneel (variable)

Materials: MDF and many other materials

Surfaces: many options depending on material

Fire Protection: many options depending on material

ONLINE - Product Range Overview

→ available formats and measures

→ available materials

→ available surfaces and colors

→ options regarding fire protection



All product options always up to date

via QR code scan or via this link → www.trikustik.at/sortiment

Application: Information on planning, processing, installation and care: www.trikustik.at

SOUND ABSORPTION VALUES

Measurement: acc. to DIN EN ISO 354

Data source: certificate by LGA/TÜV

Valid for: application at wall and ceiling

Fleece: SP50 or equivalent

Insulation: Sonorock or equivalent

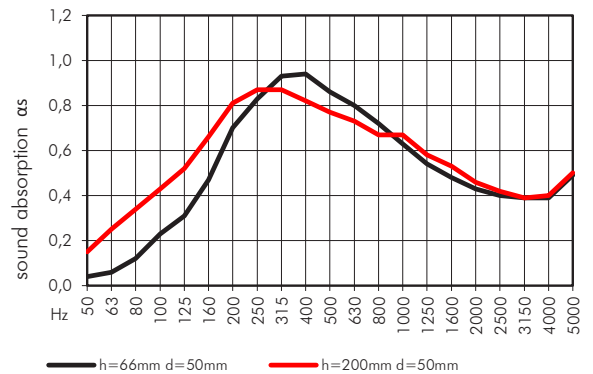
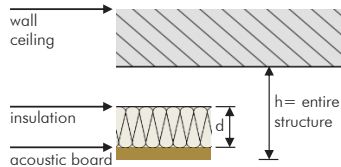

construction	Hz	50	63	80	100	125	160	200	250	315	400	500	630	800	1000	1250	1600	2000	2500	3150	4000	5000	
h=66mm d=50mm	α_s	0,04	0,06	0,12	0,23	0,31	0,47	0,70	0,83	0,93	0,94	0,86	0,80	0,72	0,63	0,54	0,48	0,43	0,40	0,39	0,39	0,49	α_w : 0,50 (LM)
	α_p		0,05			0,35			0,80			0,85			0,65			0,45			0,40		SAA: 0,69
h=200mm d=50mm	α_s	0,15	0,25	0,34	0,43	0,52	0,66	0,81	0,87	0,87	0,82	0,77	0,73	0,67	0,67	0,58	0,53	0,46	0,42	0,39	0,40	0,50	α_w : 0,55 (L)
	α_p		0,25			0,55			0,85			0,75			0,65			0,45			0,45		SAA: 0,68

Datasheet Lochform R32D12V

v5_2023_1

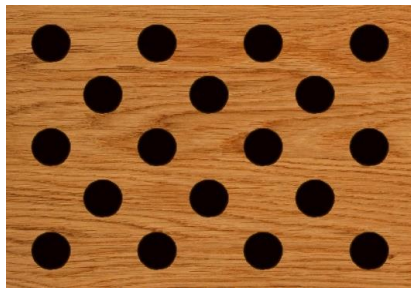

R = Grid in mm: 32,0mm
 D = Diameter in mm: 12,0mm shifted

Open surface: 22,08%

- Applicable for
- Ceiling
 - Wall
 - Cabinet door
 - Partitioning
 - Lay In

PRODUCT OPTIONS Acoustic boards from Trikustik are manufactured to order and in a wide range of variants.

Perforation: Front side: drilled (through hole)

Acoustic fleece: black, laminated on back side

Thickness: 15-19mm depending on material / other thicknesses possible on request

Edges: as Format Paneel -> industrial cut

Options: unperforated friezes according to customer requirements

- Formats:** Panel (variable)
- Materials:** MDF and many other materials
- Surfaces:** many options depending on material
- Fire Protection:** many options depending on material

ONLINE - Product Range Overview

- available formats and measures
- available materials
- available surfaces and colors
- options regarding fire protection



All product options always up to date via QR code scan or via this link → www.trikustik.at/sortiment

Application: Information on planning, processing, installation and care: www.trikustik.at

SOUND ABSORPTION VALUES

Measurement: acc. to DIN EN ISO 354

Data source: certificate by TU Graz

Valid for: application at wall and ceiling

Fleece: SP50 or equivalent

Insulation: Sonorock or equivalent

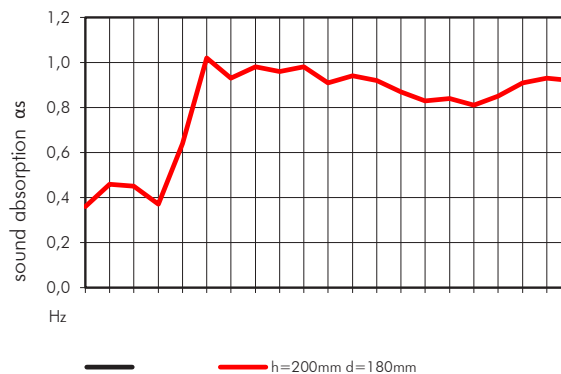
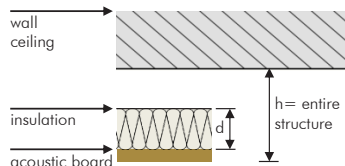

Aufbau	Hz	50	63	80	100	125	160	200	250	315	400	500	630	800	1000	1250	1600	2000	2500	3150	4000	5000	
h=200mm d=180mm	α_s	0,36	0,46	0,45	0,37	0,64	1,02	0,93	0,98	0,96	0,98	0,91	0,94	0,92	0,87	0,83	0,84	0,81	0,85	0,91	0,93	0,92	α_w : 0,90 (L) SAA: 0,90
	α_p		0,40			0,70			0,95			0,95			0,85		0,85				0,90		

Datasheet Lochform R32D16

vs_2022_7

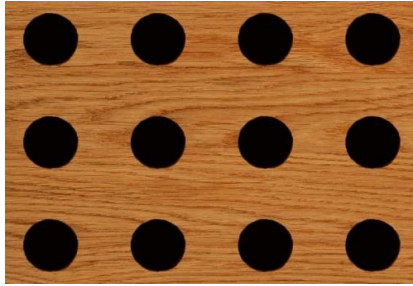

R = Grid in mm: 32,0mm
D = Diameter in mm: 16,0mm

Open surface: 19,63%

- Applicable for
- Ceiling
 - Wall
 - Cabinet door
 - Partitioning
 - Lay In

PRODUCT OPTIONS Acoustic boards from Trikustik are manufactured to order and in a wide range of variants.

Perforation: Front side: drilled (through hole)

Acoustic fleece: black, laminated on back side

Thickness: 15-19mm depending on material / other thicknesses possible on request

Edges: as Format Panel -> industrial cut

Options: unperforated friezes according to customer requirements

Formats: Panel (variable)
Materials: MDF and many other materials
Surfaces: many options depending on material
Fire Protection: many options depending on material

ONLINE - Product Range Overview

→ available formats and measures

→ available materials

→ available surfaces and colors

→ options regarding fire protection



All product options always up to date via QR code scan or via this link → www.trikustik.at/sortiment

Application: Information on planning, processing, installation and care: www.trikustik.at

SOUND ABSORPTION VALUES

Measurement: acc. to DIN EN ISO 354

Data source: certificate by TGM

Valid for: application at wall and ceiling

Fleece: SP50 or equivalent

Insulation: Sonorock or equivalent

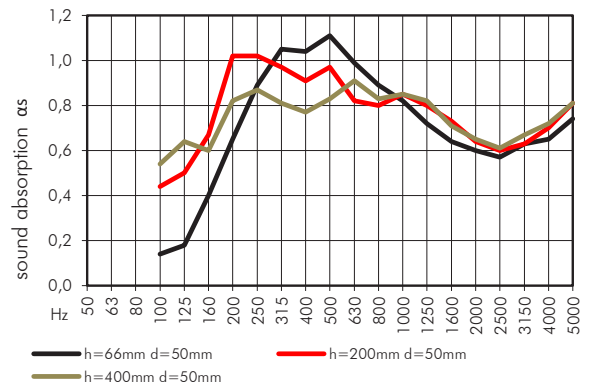
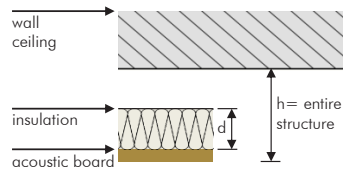

construction	Hz	50	63	80	100	125	160	200	250	315	400	500	630	800	1000	1250	1600	2000	2500	3150	4000	5000	
h=66mm d=50mm	α_s				0,14	0,18	0,40	0,65	0,89	1,05	1,04	1,11	0,99	0,89	0,82	0,72	0,64	0,60	0,57	0,63	0,65	0,74	α_w : 0,70 (LM)
	α_p					0,25			0,85			1,05			0,80			0,60			0,65		SAA: 0,83
h=200mm d=50mm	α_s				0,44	0,50	0,67	1,02	1,02	0,97	0,91	0,97	0,82	0,80	0,85	0,80	0,73	0,64	0,60	0,63	0,70	0,81	α_w : 0,75 (L)
	α_p					0,55			1,00			0,90			0,80			0,65			0,70		SAA: 0,84
h=400mm d=50mm	α_s				0,54	0,64	0,60	0,82	0,87	0,81	0,77	0,83	0,91	0,83	0,85	0,82	0,71	0,65	0,61	0,67	0,72	0,81	α_w : 0,75 (L)
	α_p					0,60			0,85			0,85			0,85			0,65			0,75		SAA: 0,79

REFERENCES

Lecture halls, auditoriums and universities

Österreichisches Parlament / BOKU Wien / JKU Linz /
IST Austria / Uni Wien / FH Hagenberg /...

Schools and kindergartens

Bildungszentrum Reith / Tourismusschule St. Johann / KIGA Bad
Sauerbrunn / VS Brunn /...

Concert and lecture halls

Stadthalle Wien / Landestheater Linz / Festspiele Bregenz /...

Music rehearsal rooms

Future Art Lab / Synchron Stage Vienna / Wiener Sängerknaben
/ Hofburg / Tonstudio ORF /...

Sports halls, gymnasiums and exercise rooms

Multiversum Schwechat / Sportpark Lissfeld /
Turnsaal Michelhausen /...

Office and meeting areas

Europäisches Parlament_Strassburg / mysugr / KPMG / Engel
GmbH / Erber Group /...

Gastronomy and commerce

The Eagle_Kreischberg / SCS / Kurhotel Bad Zell / Weingut
Högl /...

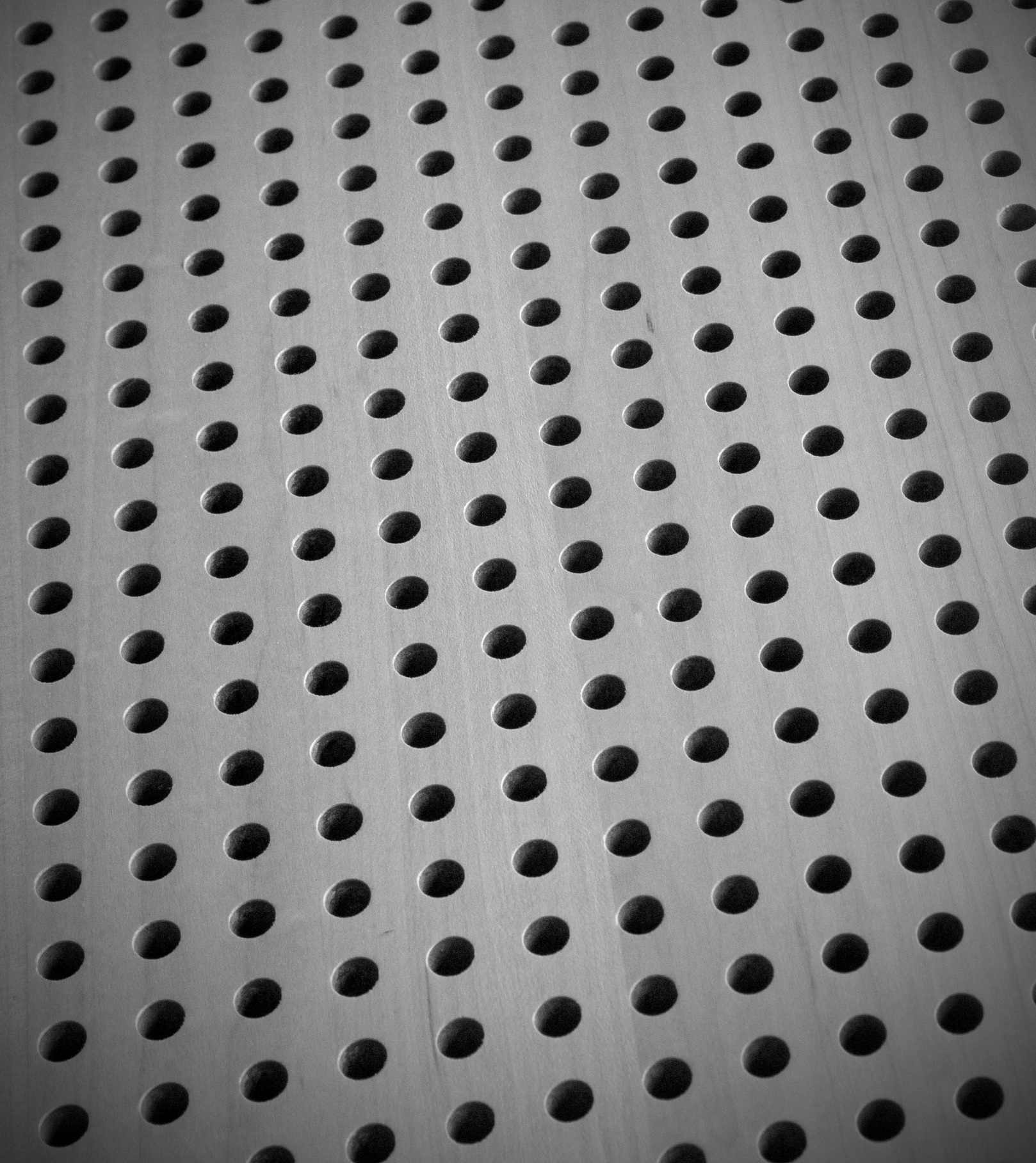

Trikustik GesmbH
Ritterkamp 8
3911 Rappottenstein
office@trikustik.at



www.trikustik.at